

# BLÜCHER® Drainage Systems

Product catalogue for drains, pipes and channels



**BLÜCHER®**

*A WATTS Brand*

STAINLESS STEEL DRAINAGE SYSTEMS



## Safe solutions

BLÜCHER® stainless steel drainage products are installed in almost any kind of construction project, from multi-storey apartments and food processing factories to hospitals and on board prestigious cruise liners. We have specialised our competencies within four main segments:

Housing

Commercial

Industrial

Marine

The BLÜCHER® drainage system is a modular system providing numerous possible product combinations.

### BLÜCHER® Drain

Floor drains for light- to heavy-duty flow and load applications.

### BLÜCHER® Channel

Standard, modular or customised channels and kitchen channels for all flow and load applications.

### BLÜCHER® EuroPipe

Push-fit drainage pipe-work system for soil, waste and rainwater.

### Customised solutions

To ensure that any drainage requirement can be fulfilled we are always ready to solve your special request.

## Strong products

All BLÜCHER® drainage products are produced in stainless steel grade AISI 304 or optionally grade AISI 316L. This material is ideally suitable for high-quality drainage systems:

- Fire resistant
- High strength - low weight
- Environmentally friendly

Furthermore it is corrosion resistant, resistant to impacts and thermal stress and requires little maintenance.

In the BLÜCHER® drainage products the inherent qualities of stainless steel are enhanced by careful product design resulting in:

- Long product life expectancy
- Excellent hygienic properties
- Easy installation
- Whole-life cost advantages
- Excellent flow capacities

All BLÜCHER® products are chemically descaled and passivated in order to enhance the natural corrosion resistance and provide a uniform matt-silver surface finish.

All stainless steel components are manufactured from recycled materials and are 100% recyclable.

## Danish quality

Founded in Denmark in 1965, BLÜCHER has developed into a leading manufacturer of stainless steel drainage systems. Today, BLÜCHER is an international company with subsidiaries and representations worldwide. The BLÜCHER Group employs more than 350 staff worldwide.

Customers all over the World appreciate our know-how, dedicated service and common sense.

Through quality stainless steel products and drainage solutions that lead waste water away, BLÜCHER is committed to the promise of keeping up the flow.

The BLÜCHER® drainage products are manufactured in Denmark using the most modern production methods and in accordance with the internationally recognised quality standard ISO 9001. Furthermore, the most respected classification societies endorse the BLÜCHER® drainage products worldwide.



## Selected references around the World

Hospitals, schools, commercial kitchens, the food and beverage industry and the pharmaceutical industry are among the customers that benefit from BLÜCHER stainless steel drainage systems.

### Housing

BLÜCHER® stainless steel floor drains and pipe system are used all over the World in Scandinavian-style wet bathrooms in single and multi-storey buildings.

### Commercial

Queen Mary Hospital, Hvidovre hospital, Princess Alexandra Hospital, Blackpool Victoria Hospital, Queen Elizabeth Hospital, St. James Hospital, University College London Hospital, Sportcentrum Fitness First, Czàsar Swimming Pool, Sports & Aquatic Centre, International Grammar School, Collège Bellevue, Elite University, Universitat Pompeu Fabra, Augustenborgskolan, Canadian International School, North Texas State University, Elderly Citizens Home Adelaide, Old Peoples Home Budapest, Maryland State Prison, Uppsala Polishus, Oslo Opera, Hilton Hotels, Hotel Marriot, Sofitel, Novotel, The Ritz Carlton Bahrain, McDonalds, Burger King, Pizza Hut, Le Louvre, Bahrain National Museum, Ministère de L'Industri, State Library of Victoria, Royal Danish Theatre, Copenhagen Zoo, Hong Kong Disneyland, Dubai Mall, IKEA, Tesco, Coop, Metro, Carrefour, Lidl, Woolworths, Gardamoen Oslo, Copenhagen Airport, Heathrow Airport, Barcelona Airport, New Athens Airport, Orly Airport, Arlanda Airport, Helsinki Airport.

### Industrial

Pfizer, GSK, Astra Zeneca, Johnson & Johnson, Aventis, Kraft, Nestlé, Danish Crown, Daloon, Tulip, Knorr, Singapore Airport Catering, Ahlgreens, Estrella, Kelloggs, CocaCola, Pepsi, Heineken, Carlsberg, Whitbread Breweries, Budweiser, Tropicana Juice Processing, Absolut Vodka. Nestlé, Arla Food, Danone, Unilever, Almarai Dairy. Mercedes, Renault, L'Oreal, Sony, BASF, 3M, IBM World Headquarters, Honeywell, Colgate Palmolive, Royal Copenhagen, Hella.

### Marine

Freedom of the Seas, Liberty of the Seas, Norwegian Star, Color Magic, Pride of Hawaii, Galaxy, AIDA Diva, Celebrity Solstice. MY Platinum (Dubai Ports Authority), M/S Caravelle (Jade Yachts), Safari (Blohm & Voss) Lady Haya (Pesaro), Pelorus (Lürssen Kröger Werft), Oceanco Kusch Yachts Agentur.  
3 vehicle carriers and 10 container ships (MHI Japan), 6 container vessels (AP Møller), 35 commercial vessels (Mawai China), 24 container vessels (Dalian Shipyards China).  
Agbami Off Shore, Consafe-Aberdeen Oil Platform Bingo I & Bingo II Offshore Oil Rigs. Auxillary vessel (British Navy), 5 frigates (Norwegian Navy), 2 logistics vessels (Danish Navy), 2 survey vessels Dutch Navy.

## Included in this catalogue:

### BLÜCHER® Drain Domestic



Shower drains for concrete/tiled and vinyl floors

- SQUARE, TRIO and CIRCLE
- Removable and easy-to-clean water trap
- Range of design gratings

WaterLine shower channels for concrete/tiled and vinyl floors

- For installation against wall(s) or away from walls
- Range of design gratings

For specifications on **BLÜCHER® Drain Domestic**, see this catalogue, pages 1 - 65

### BLÜCHER® Drain Industrial



Industrial drains for concrete/tiled, resin or vinyl floors

This chapter has been moved to a separate catalogue

classes

For specifications on **BLÜCHER® Drain Industrial**, see this catalogue, pages 66 - 120

### BLÜCHER® EuroPipe



Push-fit drainage pipes and fittings, Ø40-Ø315 mm

- Low weight, high strength
- For vacuum and gravity systems
- RS82 renovation system (see separate catalogue)

For specifications on **BLÜCHER® EuroPipe**, see this catalogue, pages 121 - 152

## The BLÜCHER range also comprises:

### BLÜCHER® Channel



Channels and kitchen channels for concrete/tiled, resin and vinyl floors

- Removable and easy-to-clean water trap
- Large range of gratings for all applications and load classes

**Order a BLÜCHER® Channel catalogue from our customer center or download from [www.blucher.com](http://www.blucher.com)**

### BLÜCHER® HygienicPro



Point and linear drains for applications with strict requirements to hygiene and high capacity, e.g. production areas in the food and beverage industry

- Quickly leads away solid waste, even at small water volumes
- No corners and cavities inside thus preventing bacterial growth
- Less production stops for emptying and cleaning filter baskets

**Order a BLÜCHER® HygienicPro® catalogue from our customer center or download from [www.blucher.com](http://www.blucher.com)**

### BLÜCHER® Drain Roof



Roof drainage system for single-ply membrane or bitumen in gravity and vacuum systems

- Roof drains and BLÜCHER® EuroPipe pipework system
- Easy installation
- Long product life expectancy

**Order a BLÜCHER® Drain Roof catalogue from our customer center or download from [www.blucher.com](http://www.blucher.com)**







## BLÜCHER® DRAIN DOMESTIC

Presentation of shower drains. . . . .	1
Shower drains SQUARE for concrete and tiled floors without membrane. . . . .	4
Shower drains SQUARE for concrete and tiled floors with liquid membrane. . . . .	9
Shower drains SQUARE for concrete and tiled floors with liquid & sheet membranes. . . . .	15
Shower drains SQUARE for concrete and tiled floors with liquid membrane and Lewis® sheeting. . . . .	16
Shower drains SQUARE for concrete and tiled floors with sheet membrane. . . . .	17
Shower drains CIRCLE for vinyl floors. . . . .	19
Lower parts for shower drains - without membrane flange. . . . .	24
Upper parts SQUARE for concrete and tiled floors. . . . .	26
Upper parts CIRCLE for resin floors. . . . .	29
Upper parts CIRCLE for vinyl floors. . . . .	31
Accessories for shower drains. . . . .	33
Presentation of shower channel WaterLine. . . . .	51
Shower channel WaterLine for concrete and tiled floors without membrane. . . . .	54
Shower channel WaterLine for concrete and tiled floors with liquid membrane. . . . .	55
Shower channel WaterLine for concrete and tiled floors with sheet membrane. . . . .	56
Shower channel WaterLine for vinyl floors. . . . .	57
Accessories for WaterLine shower channels. . . . .	58



## BLÜCHER® DRAIN INDUSTRIAL

Presentation of industrial drains. . . . .	66
Industrial drains for concrete and tiled floors without membrane. . . . .	69
Industrial drains for concrete and tiled floors with liquid membrane. . . . .	74
Industrial drains for concrete and tiled floors with sheet membrane. . . . .	78
	81
	83
	85
	87
Industrial lower parts - with sheet membrane flange. . . . .	88
Industrial upper parts for concrete and tiled floors. . . . .	89
Industrial upper parts for resin floors. . . . .	91
Industrial upper parts for vinyl floors. . . . .	92
Industrial middleparts. . . . .	93
Accessories for industrial drains. . . . .	94
Rodding eyes and gastight drains for concrete and tiled floors without membrane. . . . .	108
Rodding eyes and gastight drains for resin floors. . . . .	111
Rodding eyes and gastight drains for vinyl floors. . . . .	113
Upper parts for rodding eyes and gastight drains. . . . .	114
Accessories for rodding eyes and gastight drains. . . . .	116
Access covers. . . . .	117
Accessories for access covers. . . . .	118
Upper parts for outdoor drains. . . . .	119
Accessories for outdoor drains. . . . .	120

This chapter has been  
moved to a separate catalogue



## BLÜCHER® EUROPIPE

Presentation of BLÜCHER® EuroPipe - pipes and fittings. . . . .	121
Pipes. . . . .	124
Fittings - Bends. . . . .	126
Fittings - Branches. . . . .	129
Fittings - Access pipes and bends. . . . .	132
Fittings - Sockets. . . . .	134
Fittings - Increases and reducers. . . . .	135
Fittings - Adaptors. . . . .	136
Fittings - Rat stops. . . . .	141
Fittings - Toilet adaptors. . . . .	142
Accessories. . . . .	144
Pipe cutters and other tools. . . . .	151

## Technical information

This chapter has been  
moved to a separate catalogue



## Drains for housing and commercial applications



### Shower drains For tiled and vinyl floors Square or circular

#### Applications

For tiled and vinyl floors in:

- Private housing bathrooms
- Toilets and showers in hotels, hospitals, fitness centres, etc.

#### Details

- Square or circular frame
- Brushed grain finish
- Low frame height
- Grate with starlock screw-system
- Stainless steel AISI304/EN 1.4301 or AISI316L/EN 1.4404

#### Variants

- Side inlets  $\varnothing 32/40$  mm
- Vertical or horizontal outlet
- Flange for liquid or sheet membrane
- Adjustable height, rotation and tilt

#### Options

- Removable water trap
- Design gratings in 3 shapes and 6 designs

#### Series

- Series 100 without flange for concrete and tiled floors
- Series 200 for vinyl floors
- Series 300 with liquid or sheet membrane flange for concrete and tiled floors

## Complete drains

### Concrete and tiles without membrane



- Standard grating VIENNA included
- Optional design gratings available
- Optional filter basket
- Optional removable water trap
- Adjustable upper part
- Lower part with or without side inlets

### Concrete and tiles with liquid membrane



- Standard grating VIENNA included
- Optional design gratings available
- Optional filter basket
- Optional removable water trap
- Adjustable upper part
- Flange
- Lower part with or without side inlets

### Concrete and tiles with sheet membrane



- Standard grating VIENNA included
- Optional design gratings available
- Optional filter basket
- Optional removable water trap
- Adjustable upper part
- Adjustable clamping flange
- Lower part with or without side inlets

### Vinyl



- Standard grating VIENNA included
- Optional design gratings available
- Clamping ring
- Optional inlet deflector
- Optional filter basket
- Optional water trap
- Adjustable upper part
- Lower part with or without side inlets

### Complete drains

**Drain**  
Adjustable 2-part drains or non-adjustable 1-part drains

**Grating**  
Standard VIENNA grating is included. Optional design gratings are not included - to be ordered separately

**Water trap**  
Removable water trap not included - to be ordered separately.

**Other accessories**  
Other accessories such as filter basket not included - to be ordered separately. Most drains with side inlets come with inlet deflector.

## Installation examples

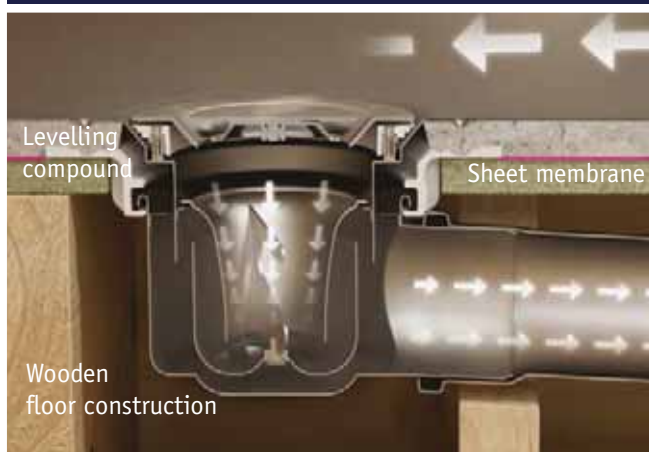
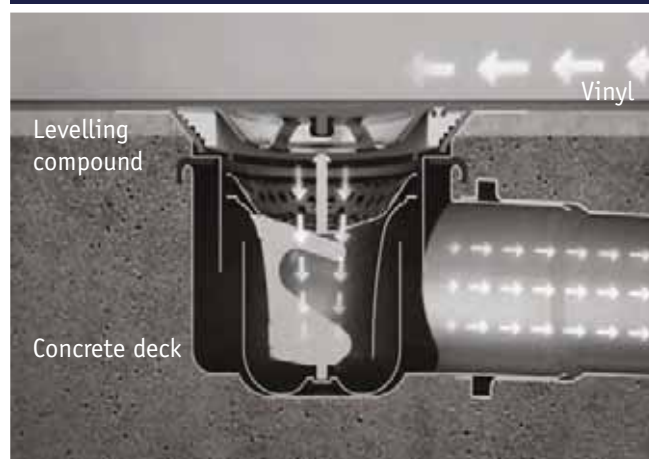
**Concrete and tiles without membrane****Concrete and tiles with liquid membrane****Concrete and tiles with sheet membrane****Vinyl****Two-part removable water trap**

Due to its design the water trap has unique self-cleansing properties, and the slanted handle does not gather hair or dirt. Separable to facilitate cleaning. After cleaning, assemble the two parts by screwing them together tightly.

Installation videos available at [www.blucher.com](http://www.blucher.com)

without membrane

**ADJUSTABLE SHOWER DRAIN SQUARE, LOW MODEL TYPE 102**

WITH SIDE INLETS AND INTEGRATED WATER TRAP

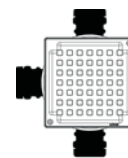
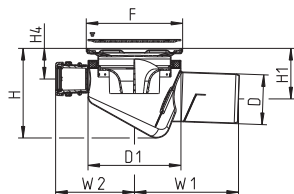

Type no.	EAN no.	D	D1	F	H	H1	H4	W1	W2
102.300.075	5705499118285	75	140	145x145	128-145	69-86	39-56	157	119

**ADJUSTABLE SHOWER DRAIN SQUARE TYPE 110**

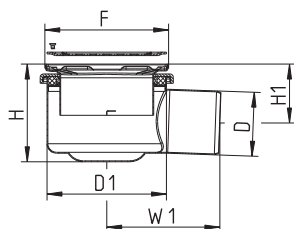

Type no.	EAN no.	D	D1	F	H	H1	W1
110.300.050	5705499124255	50	140	145x145	115-145	81-111	128
110.300.075	5705499104844	75	140	145x145	115-145	69-99	133

**ADJUSTABLE SHOWER DRAIN SQUARE TYPE 111**

WITH SIDE INLETS

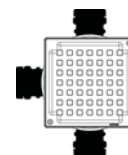
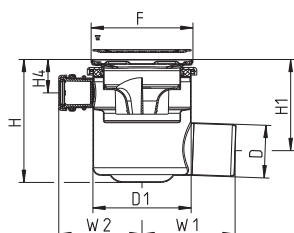

Type no.	EAN no.	D	D1	F	H	H1	H4	W1	W2
111.300.075	5705499105636	75	140	145x145	175-185	130-140	48-58	133	119

without membrane

**ADJUSTABLE SHOWER DRAIN SQUARE TYPE 111**

WITH SIDE INLETS 50 MM

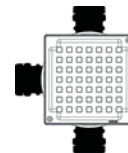
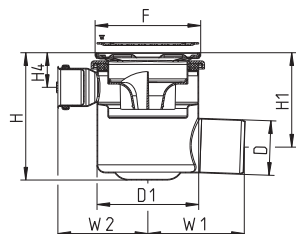

Type no.	EAN no.	D	D1	F	H	H1	H4	W1	W2
111.303.075	5705499123708	75	140	145x145	175-185	130-140	48-58	133	124

**ADJUSTABLE SHOWER DRAIN SQUARE, LOW MODEL TYPE 114**

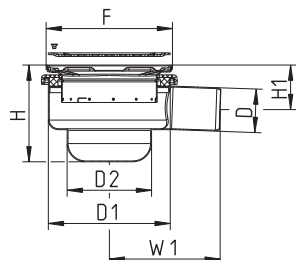

Type no.	EAN no.	D	D1	F	H	H1	W1	D2
114.300.050	5705499118056	50	140	145x145	111-121	51-61	127	97

**SHOWER DRAIN SQUARE, LOW MODEL TYPE 140**

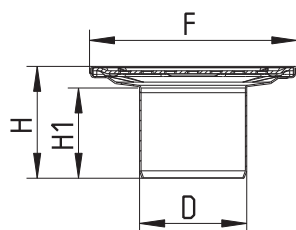

Type no.	EAN no.	D	F	H	H1
140.300.032	5705499107425	1 1/4"	145x145	39	23
140.300.040	5705499107449	40	145x145	65	49
140.300.050	5705499106510	50	145x145	74	58
140.300.075	5705499104868	75	145x145	78	63

Not for removable water trap. BSP thread

without membrane

**ADJUSTABLE SHOWER DRAIN SQUARE TYPE 150**

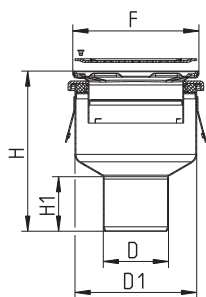

Type no.	EAN no.	D	D1	F	H	H1
150.300.050	5705499124279	50	140	145x145	189-219	58
150.300.075	5705499104882	75	140	145x145	185-215	63
150.300.110	5705499104905	110	140	145x145	152-182	79

**ADJUSTABLE SHOWER DRAIN SQUARE TYPE 151**

WITH SIDE INLETS

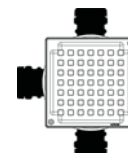
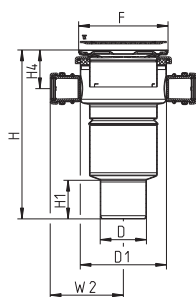

Type no.	EAN no.	D	D1	F	H	H1	H4	W2
151.300.075	5705499104929	75	140	145x145	274-304	63	63-93	119
151.300.110	5705499104943	110	140	145x145	167-197	79	63-93	119

**ADJUSTABLE SHOWER DRAIN SQUARE TYPE 151**

WITH SIDE INLETS 50 MM

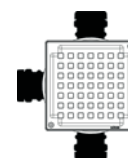
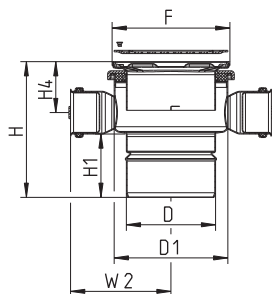

Type no.	EAN no.	D	D1	F	H	H1	H4	W2
151.303.110	5705499123715	110	140	145x145	167-197	79	63-93	124



without membrane

**ADJUSTABLE SHOWER DRAIN SQUARE TYPE 155**

WITH SIDE INLETS

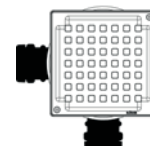
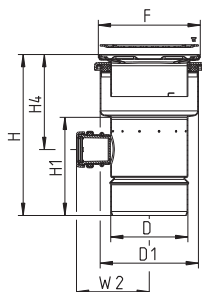

Type no.	EAN no.	D	D1	F	H	H1	H4	W2
155.300.110	5705499123838	110	140	145x145	230-260	140	136-166	104

**SHOWER DRAIN SQUARE TYPE 160**

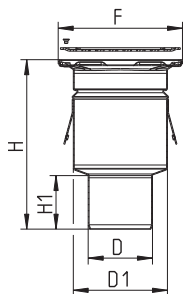

Type no.	EAN no.	D	D1	F	H	H1
160.300.050	5705499123586	50	110	145x145	193	60
160.300.075	5705499104967	75	110	145x145	198	63
160.300.110	5705499104981	110	110	145x145	91	79

**SHOWER DRAIN SQUARE TYPE 161**

WITH SIDE INLETS

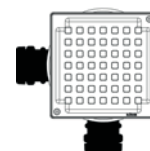
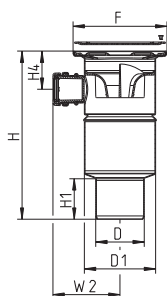

Type no.	EAN no.	D	D1	F	H	H1	H4	W2
161.300.075	5705499105001	75	110	145x145	260	63	59	104
161.300.110	5705499105025	110	110	145x145	153	141	59	104

without membrane

MINI DRAIN SQUARE TYPE 181

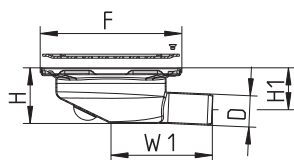

Type no.	EAN no.	D	F	H	H1	W1
181.300.032	5705499107364	32	145x145	57	43	104

Not for removable water trap. Adaptor for D=40mm included

with liquid membrane

**ADJUSTABLE SHOWER DRAIN SQUARE, LOW MODEL TYPE 302**

WITH SIDE INLETS AND INTEGRATED WATER TRAP

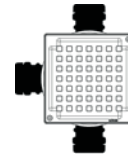
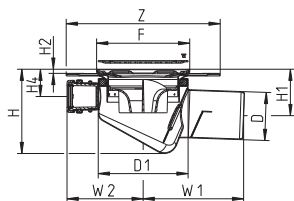

Type no.	EAN no.	D	D1	F	Z	H	H1	H2	H4	W1	W2
302.300.075	5705499118308	75	140	145x145	Ø240	132-162	72-102	6.5-21	43-73	156	119

**ADJUSTABLE SHOWER DRAIN SQUARE TYPE 310**

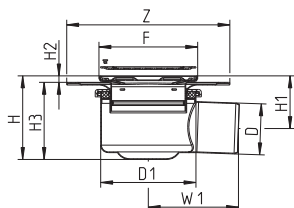

Type no.	EAN no.	D	D1	F	Z	H	H1	H2	H3	W1
310.300.050	5705499124347	50	140	145x145	Ø240	120-150	87-117	6.5-21	113-128	128
310.300.075	5705499105261	75	140	145x145	Ø240	120-150	75-105	6.5-21	113-128	133

**ADJUSTABLE SHOWER DRAIN SQUARE TYPE 311**

WITH SIDE INLETS

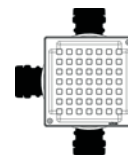
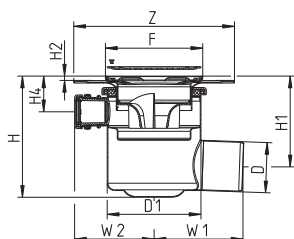

Type no.	EAN no.	D	D1	F	Z	H	H1	H2	H4	W1	W2
311.300.075	5705499105285	75	140	145x145	Ø240	181-211	136-166	6.5-21	53-83	133	119

with liquid membrane

**ADJUSTABLE SHOWER DRAIN SQUARE TYPE 311**

WITH SIDE INLETS 50 MM

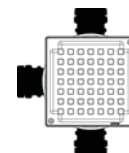
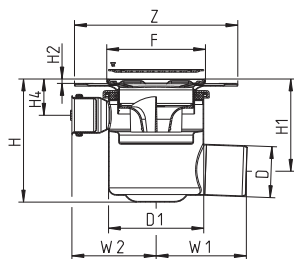

Type no.	EAN no.	D	D1	F	Z	H	H1	H2	H4	W1	W2
311.303.075	5705499123739	75	140	145x145	Ø240	181-211	136-166	6.5-21	53-83	133	124

**ADJUSTABLE SHOWER DRAIN SQUARE, LOW MODEL TYPE 314**

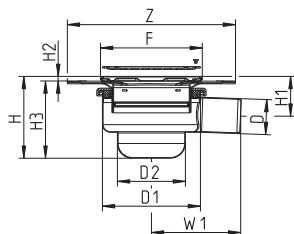

Type no.	EAN no.	D	D1	F	Z	H	H1	H2	H3	W1	D2
314.300.040	5705499113969	40	140	145x145	Ø240	117-147	52-82	6.5-21	110-125	125	97
314.300.050	5705499118094	50	140	145x145	Ø240	117-147	57-87	6.5-21	110-125	127	97

**ADJUSTABLE SHOWER DRAIN SQUARE TYPE 350**

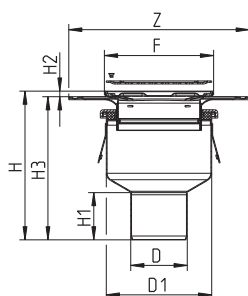

Type no.	EAN no.	D	D1	F	Z	H	H1	H2	H3
350.300.050	5705499124361	50	140	145x145	Ø240	194-224	58	6.5-21	188-203
350.300.075	5705499105346	75	140	145x145	Ø240	190-220	63	6.5-21	184-199
350.300.110	5705499105360	110	140	145x145	Ø240	158-188	79	6.5-21	152-167

with liquid membrane

**ADJUSTABLE SHOWER DRAIN SQUARE TYPE 351**

WITH SIDE INLETS

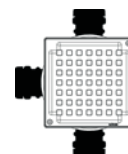
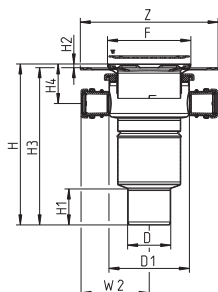

Type no.	EAN no.	D	D1	F	Z	H	H1	H2	H3	H4	W2
351.300.075	5705499105384	75	140	145x145	Ø240	280-310	63	6.5-21	274-289	69-99	119
351.300.110	5705499105407	110	140	145x145	Ø240	173-203	79	6.5-21	167-182	69-99	119

**ADJUSTABLE SHOWER DRAIN SQUARE TYPE 351**

WITH SIDE INLETS 50 MM

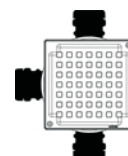
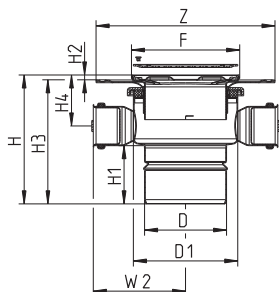

Type no.	EAN no.	D	D1	F	Z	H	H1	H2	H3	H4	W2
351.303.110	5705499124408	110	140	145x145	Ø240	173-203	79	6.5-21	167-182	69-99	124

**ADJUSTABLE SHOWER DRAIN SQUARE TYPE 355**

WITH SIDE INLETS

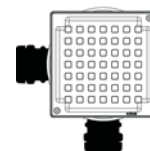
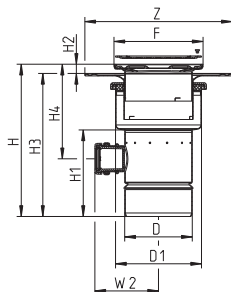

Type no.	EAN no.	D	D1	F	Z	H	H1	H2	H3	H4	W2
355.300.110	5705499107654	110	140	145x145	Ø240	235-295	140	6.5-21	229-274	141-201	104

with liquid membrane

**ADJUSTABLE SHOWER DRAIN SQUARE TYPE 360**

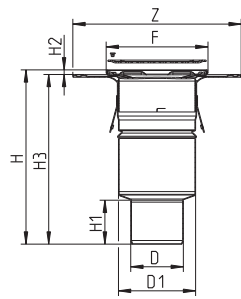

Type no.	EAN no.	D	D1	F	Z	H	H1	H2	H3
360.300.050	5705499124385	50	110	145x145	Ø240	244-259	60	6.5-21	237
360.300.075	5705499105506	75	110	145x145	Ø240	249-264	63	6.5-21	242
360.300.110	5705499105520	110	110	145x145	Ø240	142-157	-	6.5-21	135

Flange is not adjustable.

**ADJUSTABLE SHOWER DRAIN SQUARE TYPE 361**

WITH SIDE INLETS

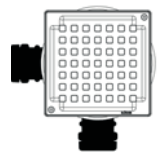
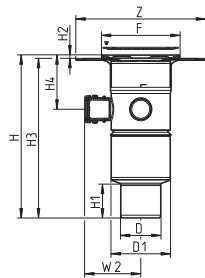

Type no.	EAN no.	D	D1	F	Z	H	H1	H2	H3	H4	W2
361.300.075	5705499105544	75	110	145x145	Ø240	302-317	63	6.5-21	295	100-115	104
361.300.110	5705499105568	110	110	145x145	Ø240	195-210	-	6.5-21	188	100-115	104

Flange is not adjustable.

**MINI DRAIN SQUARE TYPE 381**

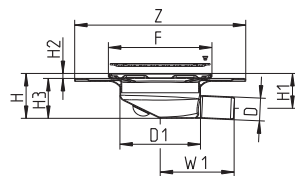

Type no.	EAN no.	D	D1	F	Z	H	H1	H2	H3	W1
381.300.032	5705499107401	32	113	145x145	Ø240	62-72	49-59	6-16	56	104

Not for removable water trap. Adaptor for D=40mm included.  
Flange is not adjustable.



with liquid membrane

**ADJUSTABLE SHOWER DRAIN SQUARE, LOW MODEL TYPE 382**

WITH REMOVABLE WATER TRAP

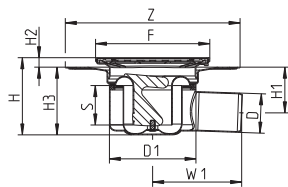

Type no.	EAN no.	D	D1	F	Z	H	H1	H2	H3	S	W1
382.300.050 V	5705499131772	50	110	145x145	Ø222	95-105	58	9-19	86	50	113

**ADJUSTABLE SHOWER DRAIN SQUARE TYPE 310.390**

WITH TWO FLANGES

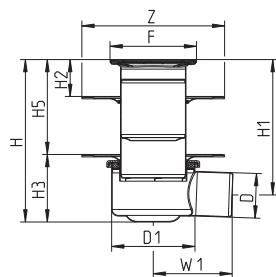

Type no.	EAN no.	D	D1	F	Z	H	H1	H2	H3	H5	W1
310.390.075	5705499127683	75	140	145x145	Ø240	273-301	228-256	6-153	114-128	160-172	133

**ADJUSTABLE SHOWER DRAIN SQUARE TYPE 314.390**

WITH TWO FLANGES

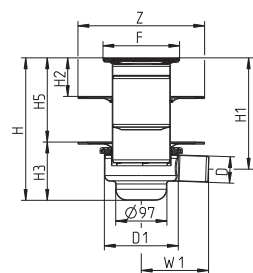

Type no.	EAN no.	D	D1	F	Z	H	H1	H2	H3	H5	W1
314.390.050	5705499127690	50	140	145x145	Ø240	270-298	211-239	6-153	111-125	160-172	127

with liquid membrane

**ADJUSTABLE SHOWER DRAIN SQUARE TYPE 350.320**

WITH REMOVABLE WATER TRAP

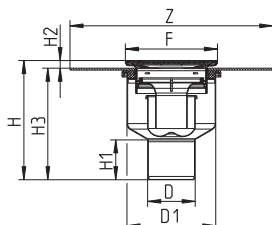

Type no.	EAN no.	D	D1	F	Z	H	H1	H2	H3
350.320.050 V	5705499127645	50	140	145x145	Ø320	192-224	58	12-26	180-208
350.320.075 V	5705499127652	75	140	145x145	Ø320	188-220	63	12-26	176-194
350.320.110 V	5705499127669	110	140	145x145	Ø320	156-188	44	12-26	144-162

**ADJUSTABLE SHOWER DRAIN SQUARE TYPE 350.390**

WITH TWO FLANGES

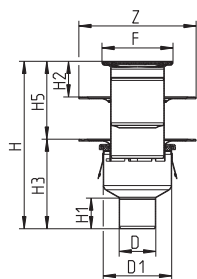

Type no.	EAN no.	D	D1	F	Z	H	H1	H2	H3	H5
350.390.050	5705499127706	50	140	145x145	Ø240	275-363	58	6-153	188-203	73-160
350.390.075	5705499127713	75	140	145x145	Ø240	272-359	63	6-153	184-199	73-160
350.390.110	5705499127720	110	140	145x145	Ø240	274-327	79	6-153	152-167	107-160

with liquid & sheet membranes

**ADJUSTABLE SHOWER DRAIN SQUARE TYPE 312.390**

WITH TWO FLANGES

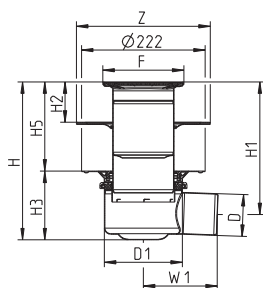

Type no.	EAN no.	D	D1	F	Z	H	H1	H2	H3	H5	W1
312.390.050	5705499134353	50	140	145x145	Ø240	272-298	238-266	6-150	123-138	148-160	128
312.390.075	5705499134346	75	140	145x145	Ø240	272-298	226-254	6-150	123-138	148-160	133

**ADJUSTABLE SHOWER DRAIN SQUARE TYPE 352.390**

WITH TWO FLANGES

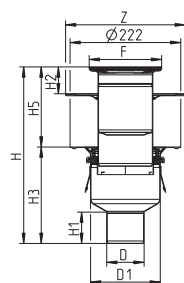

Type no.	EAN no.	D	D1	F	Z	H	H1	H2	H3	H5
352.390.050	5705499134360	50	140	145x145	Ø240	275-372	59	6-150	197-212	62-160
352.390.075	5705499134377	75	140	145x145	Ø240	273-368	63	6-150	193-208	64-160
352.390.110	5705499134384	110	140	145x145	Ø240	275-336	79	6-150	161-176	98-160

with liquid membrane and Lewis® sheeting

**ADJUSTABLE SHOWER DRAIN SQUARE TYPE 310**

FOR LEWIS® PLATES

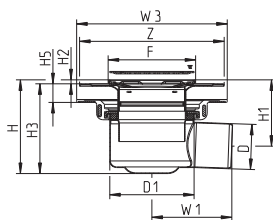

Type no.	EAN no.	D	D1	F	Z	H	H1	H2	H3	H5	W1	W3
310.340.075	5705499120257	75	140	145x145	Ø240	156-200	110-155	6-21	149-179	31-61	133	250

**ADJUSTABLE SHOWER DRAIN SQUARE TYPE 350**

FOR LEWIS® PLATES

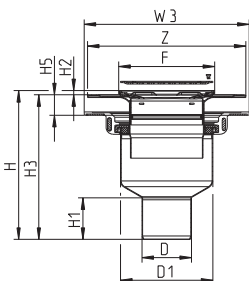

Type no.	EAN no.	D	D1	F	Z	H	H1	H2	H3	H5	W3
350.340.075	5705499120264	75	140	145x145	Ø240	226-271	63	6-21	219-249	31-61	250

**ADJUSTABLE SHOWER DRAIN SQUARE TYPE 351**

FOR LEWIS® PLATES, WITH SIDE INLETS

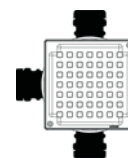
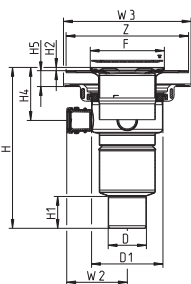

Type no.	EAN no.	D	D1	F	Z	H	H1	H2	H4	H5	W2	W3
351.340.075	5705499120271	75	140	145x145	Ø240	316-361	63	6-21	104-149	31-61	119	250

with sheet membrane

**ADJUSTABLE SHOWER DRAIN SQUARE TYPE 312**

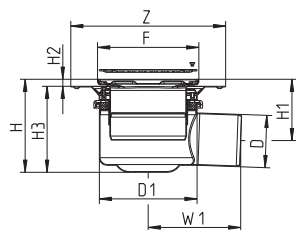

Type no.	EAN no.	D	D1	F	Z	H	H1	H2	H3	W1
312.300.075	5705499105308	75	140	145x145	Ø222	133-188	88-143	10-50	123-138	133

**ADJUSTABLE SHOWER DRAIN SQUARE TYPE 313**

WITH SIDE INLETS

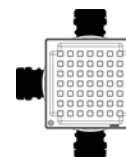
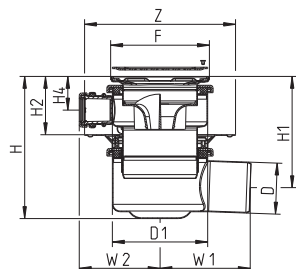

Type no.	EAN no.	D	D1	F	Z	H	H1	H2	H4	W1	W2
313.300.075	5705499105322	75	140	145x145	Ø222	199-264	154-219	76-126	48-58	133	119

**ADJUSTABLE SHOWER DRAIN SQUARE TYPE 352**

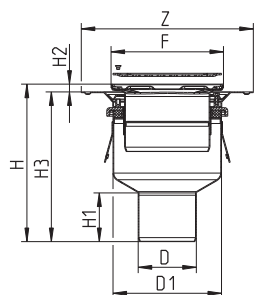

Type no.	EAN no.	D	D1	F	Z	H	H1	H2	H3
352.300.075	5705499105421	75	140	145x145	Ø222	203-258	63	10-50	193-208
352.300.110	5705499105445	110	140	145x145	Ø222	171-226	79	10-50	161-176

with sheet membrane

**ADJUSTABLE SHOWER DRAIN SQUARE TYPE 353**

WITH SIDE INLETS

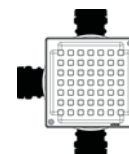
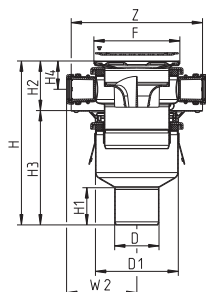

Type no.	EAN no.	D	D1	F	Z	H	H1	H2	H3	H4	W2
353.300.075	5705499105469	75	140	145x145	Ø222	269-334	63	76-126	193-208	48-58	119
353.300.110	5705499105483	110	140	145x145	Ø222	237-302	79	76-126	161-176	48-58	119



**ADJUSTABLE SHOWER DRAIN CIRCLE, LOW MODEL TYPE 202**

WITH SIDE INLETS AND INTEGRATED WATER TRAP

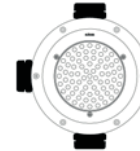
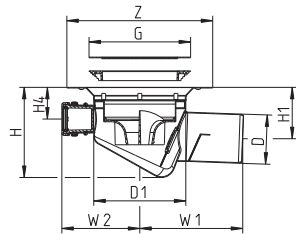

Type no.	EAN no.	D	D1	Z	G	H	H1	H4	W1	W2
202.300.075	5705499118292	75	140	Ø222	Ø155	137-152	78-93	48-63	157	119

**ADJUSTABLE SHOWER DRAIN CIRCLE TYPE 210**

Typenr.: 210.300.075  
1:5  
080130 JO

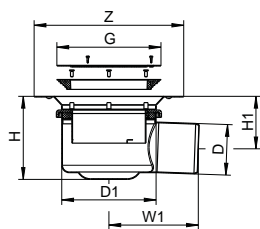

Type no.	EAN no.	D	D1	Z	G	H	H1	W1
210.300.050	5705499124316	50	140	Ø222	Ø155	123-153	90-120	128
210.300.075	5705499105049	75	140	Ø222	Ø155	123-153	78-108	133

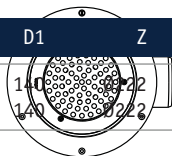

**ADJUSTABLE SHOWER DRAIN CIRCLE TYPE 211**

WITH SIDE INLETS

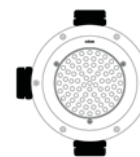
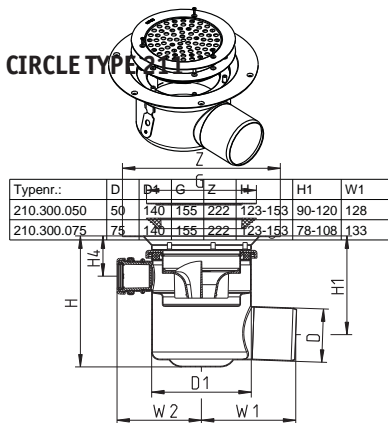

Type no.	EAN no.	D	D1	Z	G	H	H1	H4	W1	W2
211.300.075	5705499105063	75	140	Ø222	Ø155	184-194	139-149	57-67	133	119

**ADJUSTABLE SHOWER DRAIN CIRCLE TYPE 211**

WITH SIDE INLETS 50 MM

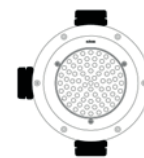
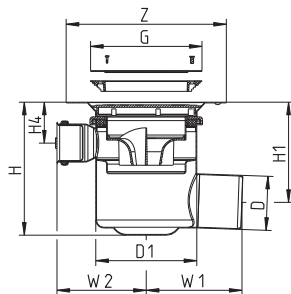

Type no.	EAN no.	D	D1	Z	G	H	H1	H4	W1	W2
211.303.075	5705499123722	75	140	Ø222	Ø155	183-193	139-149	57-67	133	124

**ADJUSTABLE SHOWER DRAIN CIRCLE, LOW MODEL TYPE 214**

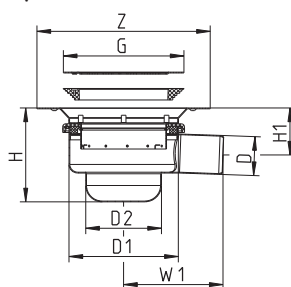

Type no.	EAN no.	D	D1	Z	G	H	H1	W1	D2
214.300.050	5705499118070	50	140	Ø222	Ø155	120-130	60-70	127	97

**SHOWER DRAIN CIRCLE, LOW MODEL TYPE 240**

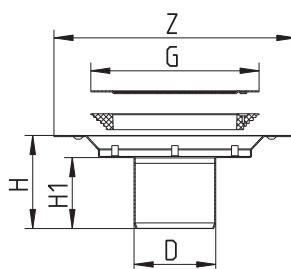

Type no.	EAN no.	D	Z	G	H	H1
240.300.050	5705499106534	50	Ø222	Ø155	81	60
240.300.075	5705499105087	75	Ø222	Ø155	86	65

Not for removable water trap

**ADJUSTABLE SHOWER DRAIN CIRCLE TYPE 250**

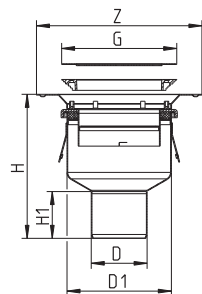

Type no.	EAN no.	D	D1	Z	G	H	H1
250.300.050	5705499123562	50	140	Ø222	Ø155	197-227	58
250.300.075	5705499105100	75	140	Ø222	Ø155	193-223	63
250.300.110	5705499105124	110	140	Ø222	Ø155	161-191	79

**ADJUSTABLE SHOWER DRAIN CIRCLE TYPE 251**

WITH SIDE INLETS

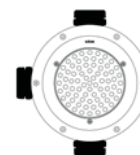
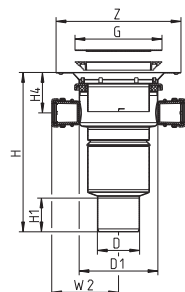

Type no.	EAN no.	D	D1	Z	G	H	H1	H4	W2
251.300.075	5705499105148	75	140	Ø222	Ø155	283-313	63	72-102	119
251.300.110	5705499105162	110	140	Ø222	Ø155	176-206	79	72-102	119

**ADJUSTABLE SHOWER DRAIN CIRCLE TYPE 251**

WITH SIDE INLETS 50 MM

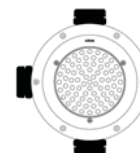
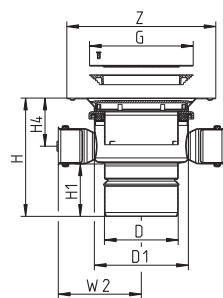

Type no.	EAN no.	D	D1	Z	G	H	H1	H4	W2
251.303.110	5705499123555	110	140	Ø222	Ø155	176-206	79	72-102	124

**SHOWER DRAIN CIRCLE TYPE 260**

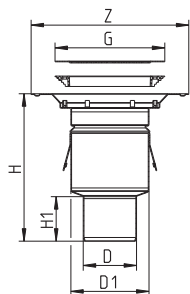

Type no.	EAN no.	D	D1	Z	G	H	H1
260.300.050	5705499123548	50	110	Ø222	Ø155	203	60
260.300.075	5705499105186	75	110	Ø222	Ø155	208	63
260.300.110	5705499105209	110	110	Ø222	Ø155	101	80

**SHOWER DRAIN CIRCLE TYPE 261**

WITH SIDE INLETS

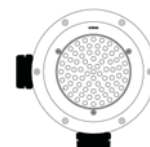
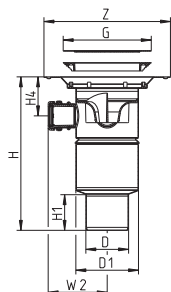

Type no.	EAN no.	D	D1	Z	G	H	H1	H4	W2
261.300.075	5705499105223	75	110	Ø222	Ø155	270	63	69	104
261.300.110	5705499105247	110	110	Ø222	Ø155	163	-	69	104

**MINI DRAIN CIRCLE TYPE 281**

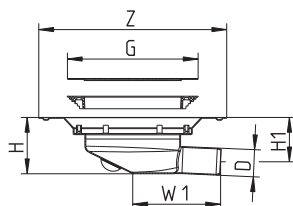

Type no.	EAN no.	D	Z	G	H	H1	W1
281.300.032	5705499107388	32	Ø222	Ø155	67	52	104

Not for removable water trap. Adaptor for D=40mm included.

**SHOWER DRAIN CIRCLE TYPE 283**

WITH REMOVABLE WATER TRAP

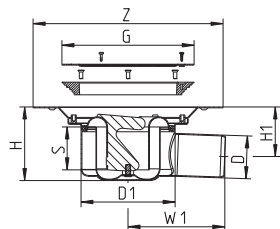

Type no.	EAN no.	D	D1	Z	G	H	H1	S	W1
283.300.050 V	5705499134964	50	110	Ø222	Ø155	86	58	50	113
283.300.050 VS	5705499134971	50	110	Ø222	Ø155	86	58	50	113

- without membrane flange

**LOWER PART FOR SHOWER DRAIN TYPE 110**

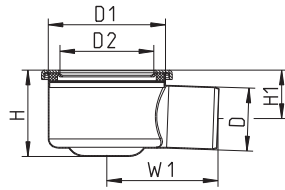

Type no.	EAN no.	D	D1	H	H1	W1	D2
110.000.050	5705499126914	50	140	103	70	128	113
110.000.075	5705499107036	75	140	103	58	133	113
110.000.110	5705499129403	110	140	124	71	143	113

Suitable for all upper parts and flanges with D=110mm or D=113mm.

**LOWER PART FOR SHOWER DRAIN TYPE 111**

WITH SIDE INLETS

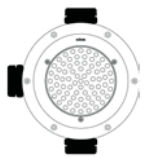
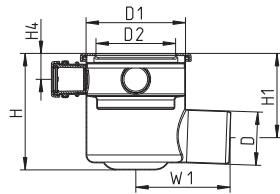

Type no.	EAN no.	D	D1	H	H1	H4	W1	D2
111.000.075	5705499107050	75	140	164	119	36	133	113

Suitable for all upper parts and flanges with D=110mm or D=113mm.

**LOWER PART FOR SHOWER DRAIN TYPE 150**

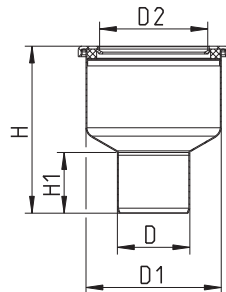

Type no.	EAN no.	D	D1	H	H1	D2
150.000.050	5705499107524	50	140	177	58	113
150.000.075	5705499107074	75	140	173	63	113
150.000.110	5705499107098	110	140	141	79	113

Suitable for all upper parts and flanges with D=110mm or D=113mm.



- without membrane flange

**LOWER PART FOR SHOWER DRAIN TYPE 151**

WITH SIDE INLETS

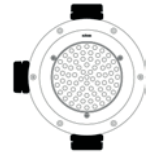
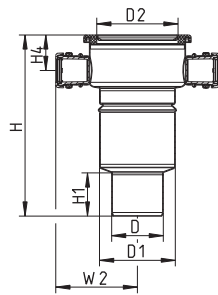

Type no.	EAN no.	D	D1	H	H1	H4	W2	D2
151.000.075	5705499107111	75	140	263	63	52	119	113
151.000.110	5705499107135	110	140	151	79	52	119	113

Suitable for all upper parts and flanges with D=110mm or D=113mm.

**UPPER PART FOR SHOWER DRAIN SQUARE TYPE 110**

WITHOUT SUPPORTING RING

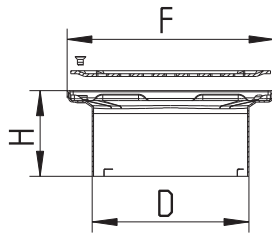

Type no.	EAN no.	D	F	H
110.300.000	5705499106916	110	145x145	60

Suitable for adjustable drain type 110, 151, 155, 351, 355, 360 and 361.  
And for adjustable drain type 150 and 350 with outlet D=110mm.

**UPPER PART FOR SHOWER DRAIN SQUARE, EXTRA LENGTH TYPE 110**

WITHOUT SUPPORTING RING

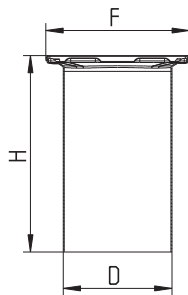

Type no.	EAN no.	D	F	H
110.300.001	5705499107210	110	145x145	199

Suitable for adjustable drain type 360,  
and for all adjustable drains with one or more of the following characteristics:  
- horizontal outlet  
- outlet D=110mm  
- side inlets

Please note: To extend the height of shower drain type 3XX we recommend using extra-length flange type 326.300.001 (see accessories)

**UPPER PART FOR SHOWER DRAIN SQUARE TYPE 111**

WITHOUT SUPPORTING RING

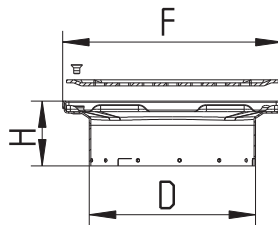

Type no.	EAN no.	D	F	H
111.300.000	5705499106893	110	145x145	43

Suitable for adjustable drain type 102, 111, 114, 302, 311, 313 and 353.

**UPPER PART FOR SHOWER DRAIN SQUARE TYPE 150**

WITH SUPPORTING RING FOR WATER TRAP

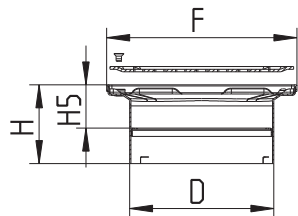

Type no.	EAN no.	D	F	H	H5
150.300.000	5705499106954	110	145x145	60	33

Suitable for adjustable drain type 150 with outlet D=50mm or D=75mm

**UPPER PART FOR SHOWER DRAIN SQUARE, EXTRA LENGTH TYPE 150**

WITH SUPPORTING RING FOR WATER TRAP

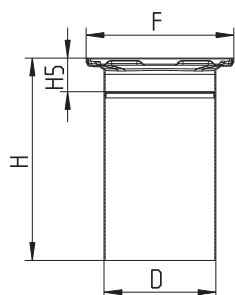

Type no.	EAN no.	D	F	H	H5
150.300.001	5705499107234	110	145x145	199	33

Suitable for adjustable drain type 150, 350 and 352 with outlet D=50mm or D=75mm.

Please note: To extend the height of shower drain type 3XX we recommend using extra-length flange type 326.300.001 (see accessories)

**UPPER PART FOR SHOWER DRAIN SQUARE TYPE 310**

WITH SUPPORTING RING FOR WATER TRAP

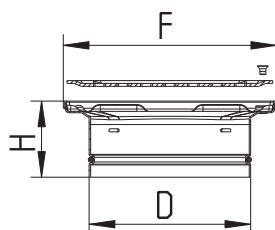

Type no.	EAN no.	D	F	H
310.300.000	5705499118018	110	145x145	52

Suitable for adjustable drain type 310 and 314.  
And for adjustable drain type 150 with outlet D=50mm or D=75mm.

**UPPER PART FOR SHOWER DRAIN SQUARE TYPE 312**

WITH SUPPORTING RING FOR WATER TRAP

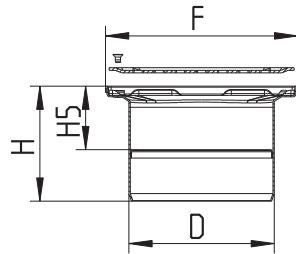

Type no.	EAN no.	D	F	H	H5
312.300.000	5705499106930	110	145x145	87	48

Suitable for adjustable drain type 312 and 352.

**UPPER PART FOR SHOWER DRAIN SQUARE TYPE 381**

WITHOUT SUPPORTING RING

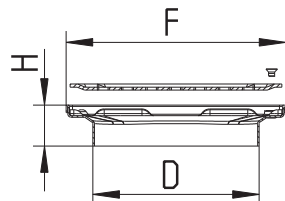

Type no.	EAN no.	D	F	H
381.300.000	5705499118421	110	145x145	27

Suitable for adjustable drain type 381.

**UPPER PART FOR SHOWER DRAIN CIRCLE TYPE 110.320.000**

WITHOUT SUPPORTING RING

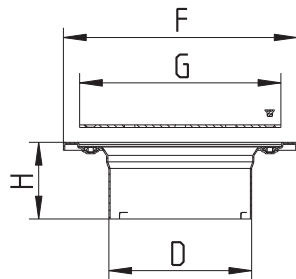

Type no.	EAN no.	D	F	G	H
110.320.000 S	5705499118032	110	Ø180	Ø155	59

**UPPER PART FOR SHOWER DRAIN CIRCLE TYPE 110.320.100**

WITHOUT SUPPORTING RING

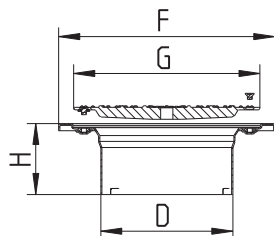

Type no.	EAN no.	D	F	G	H
110.320.100 S	5705499131871	110	Ø180	Ø155	59

**UPPER PART FOR SHOWER DRAIN CIRCLE TYPE 150.320.000**

WITH SUPPORTING RING FOR WATER TRAP

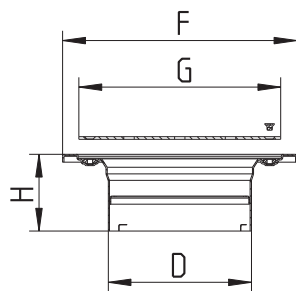

Type no.	EAN no.	D	F	G	H
150.320.000 S	5705499118049	110	Ø180	Ø155	59

**UPPER PART FOR SHOWER DRAIN CIRCLE TYPE 150.320.100**

WITH SUPPORTING RING FOR WATER TRAP

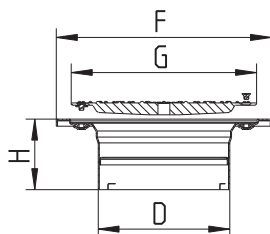

Type no.	EAN no.	D	F	G	H
150.320.100 S	5705499131888	110	Ø180	Ø155	59

**UPPER PART FOR SHOWER DRAIN CIRCLE TYPE 210**

WITHOUT SUPPORTING RING

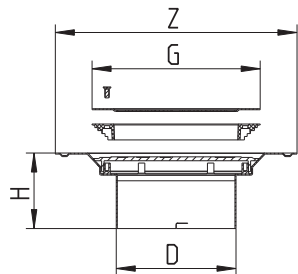

Type no.	EAN no.	D	Z	G	H
210.300.000	5705499106992	110	Ø222	Ø155	70

Suitable for adjustable drain type 210 and 251.  
And for adjustable drain type 250 with outlet D=110mm.

**UPPER PART FOR SHOWER DRAIN CIRCLE, EXTRA LENGTH TYPE 210**

WITHOUT SUPPORTING RING

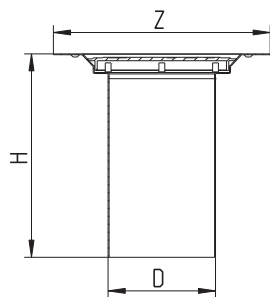

Type no.	EAN no.	D	Z	H
210.300.001	5705499117981	110	Ø222	209

Suitable for all adjustable drains with one or more of the following characteristics:  
- horizontal outlet  
- outlet D=110mm  
- side inlets

**UPPER PART FOR SHOWER DRAIN CIRCLE TYPE 211**

WITHOUT SUPPORTING RING

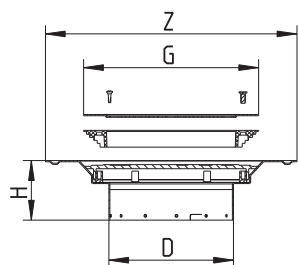

Type no.	EAN no.	D	Z	G	H
211.300.000	5705499106978	110	Ø222	Ø155	53

Suitable for adjustable drain type 202, 211, 214 and 253.

**UPPER PART FOR SHOWER DRAIN CIRCLE TYPE 250**

WITH SUPPORTING RING FOR WATER TRAP

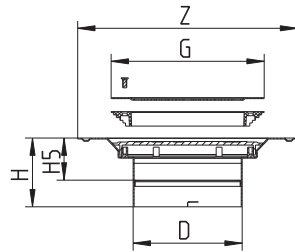

Type no.	EAN no.	D	Z	G	H	H5
250.300.000	5705499107012	110	Ø222	Ø155	70	43

Suitable for adjustable drain type 250 with outlet D=50mm or D=75mm.

**UPPER PART FOR SHOWER DRAIN CIRCLE, EXTRA LENGTH TYPE 250**

WITH SUPPORTING RING FOR WATER TRAP

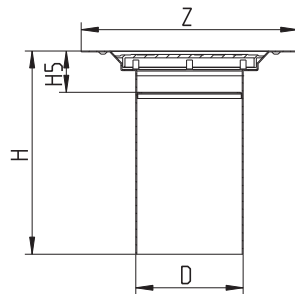

Type no.	EAN no.	D	Z	H	H5
250.300.001	5705499118001	110	Ø222	209	43

Suitable for adjustable drain type 250 with outlet D=50mm or D=75mm.



## Gratings SQUARE

### GRATING SQUARE ATHENS

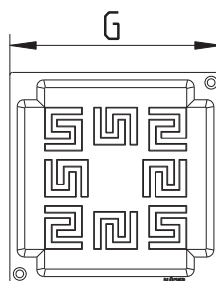
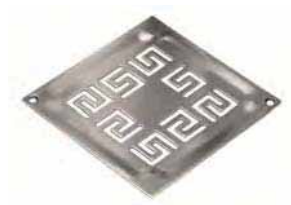

Type no.	EAN no.	G	T	Screws
610.155.427	5705499122848	140x140	2	2

### GRATING SQUARE COPENHAGEN

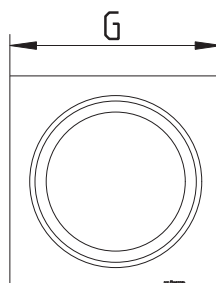
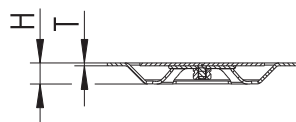

Type no.	EAN no.	G	H	T	Screws
610.155.521	5705499102192	140x140	16	2	0

### GRATING SQUARE DETROIT

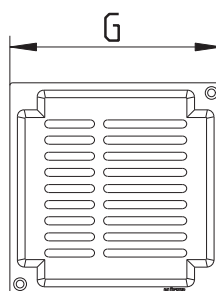

Type no.	EAN no.	G	T	Screws
610.155.428	5705499122916	140x140	2	2

## Gratings SQUARE

### GRATING SQUARE NEW YORK

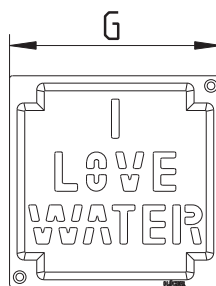
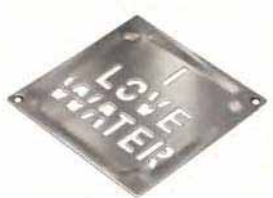

Type no.	EAN no.	G	T	Screws
610.155.429	5705499122985	140x140	2	2

### GRATING SQUARE OSLO

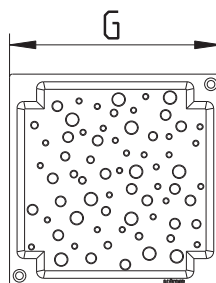

Type no.	EAN no.	G	T	Screws
610.155.426	5705499122770	140x140	2	2

### GRATING SQUARE VIENNA

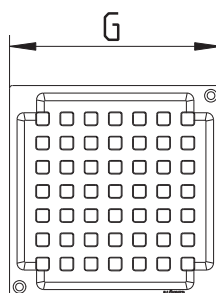

Type no.	EAN no.	G	T	Screws
610.155.421	5705499102116	140x140	2	2

Gratings SQUARE

GRATING SQUARE VIENNA, CUT A

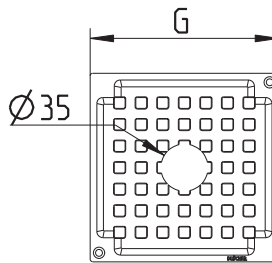

Type no.	EAN no.	G	T	Screws
610.155.441 A	5705499102161	140x140	2	2

GRATING SQUARE VIENNA, CUT B

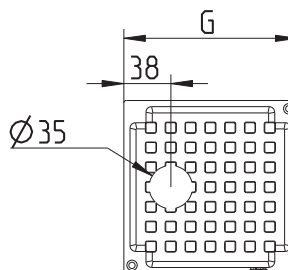

Type no.	EAN no.	G	T	Screws
610.155.441 B	5705499102178	140x140	2	2

GRATING SQUARE HYGIENIC-PRO

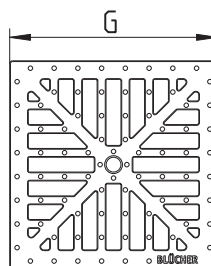
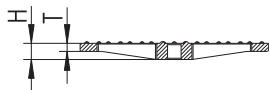

Type no.	EAN no.	G	H	T	EN1253	Screws
610.155.500	5705499128369	140x140	12	6	L 3000 kg	0
610.155.501	5705499128376	140x140	12	6	L 3000 kg	2

## Gratings SQUARE

### HINGED GRATING SQUARE

WITH HINGED COVER

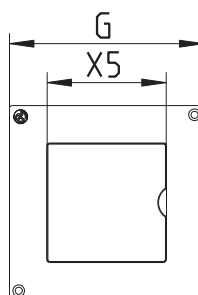
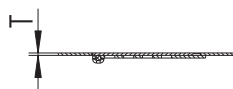

Type no.	EAN no.	G	X5	T	Screws
610.155.550	5705499120004	140x140	86x86	2	2

### BLANK PLATE SQUARE

WITH 1¼" BOTTOM VALVE

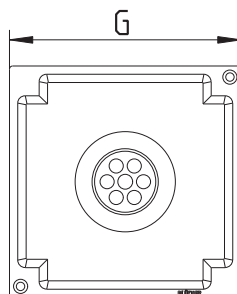
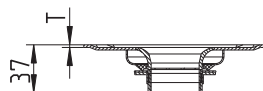

Type no.	EAN no.	G	T	Screws
610.155.451	5705499102185	140x140	2	2

BSP thread.

Cannot be mounted in drains type 110, 114, 140, 150, 160, 310, 314, 350 og 352 except in special cases - Please contact BLÜCHER

## Gratings CIRCLE

### GRATING CIRCLE COPENHAGEN

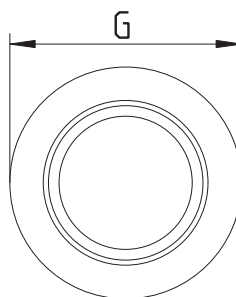
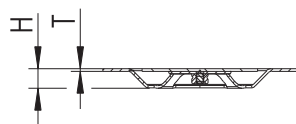

Type no.	EAN no.	G	H	T	Screws
610.160.521	5705499114164	Ø160	16	2	0
651.155.521	5705499114317	Ø155	16	2	3

### GRATING CIRCLE VIENNA

FOR VINYL FLOORS

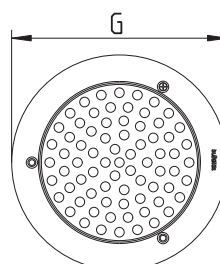

Type no.	EAN no.	G	T	Screws
620.155.011	5705499102642	Ø155	1	3

### GRATING CIRCLE HYGIENIC-PRO

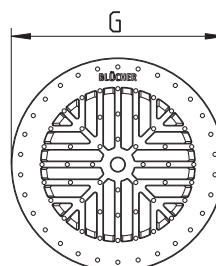
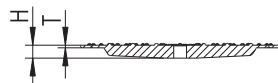

Type no.	EAN no.	G	H	T	EN1253	Screws
620.155.500	5705499128406	Ø155	10	2	L 3000 kg	0
620.155.501	5705499128413	Ø155	10	2	L 3000 kg	2

Fits into upper parts CIRCLE for resin floors

Water traps

REMOVABLE TWO-PART WATER TRAP TYPE 502.050

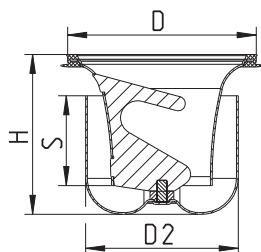

Type no.	EAN no.	D	H	S	D2	Max Flow (l/s)
502.050.110	5705499124064	108	89	50	85	1.7

Fits into all drains except type X10, X11 and X14 produced before 2008.  
Accurate flow rate depending on type of drain and grating.

REMOVABLE WATER TRAP TYPE 502.052

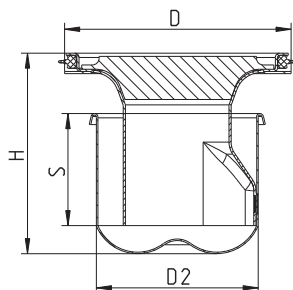

Type no.	EAN no.	D	H	S	D2	Max Flow (l/s)
502.052.110	5705499105582	108	93	52	75	1.3

Accurate flow rate depending on type of drain and grating.

REMOVABLE WATER TRAP TYPE 502.052

WITH CR SEALING RING

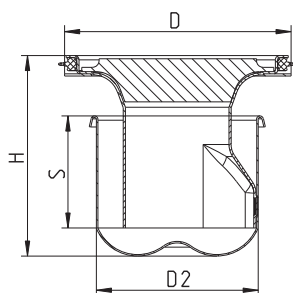

Type no.	EAN no.	D	H	S	D2	Max Flow (l/s)
502.052.110 CR	5705499114010	108	93	52	75	1.3

Accurate flow rate depending on type of drain and grating.

Water traps

REMOVABLE WATER TRAP TYPE 502.082

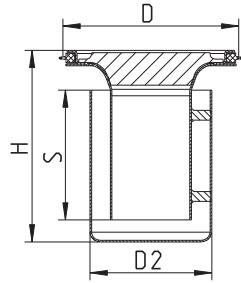

Type no.	EAN no.	D	H	S	D2
502.082.110 S	5705499128468	108	118	80	75

Water seal height = 80mm.  
Fits into all drains with Ø110 mm vertical outlet.

REMOVABLE WATER TRAP FIRE PROOF TYPE 502.052

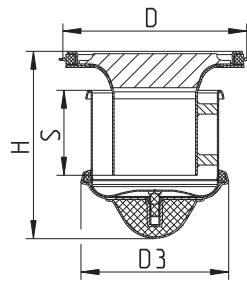

Type no.	EAN no.	D	H	S	D3	Max Flow (l/s)
502.052.110 FS	5705499120509	108	110	50	87	1.2

Fits only shower drains with vertical outlet D=50mm or D=75mm.  
Accurate flow rate depending on type of drain and grating.

REMOVABLE MULTI WATER TRAP TYPE 503

PREVENTS SMELL AND BACK FLOW

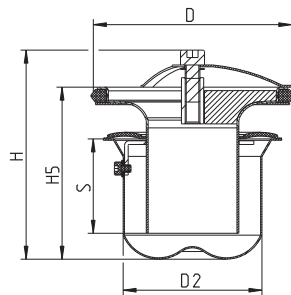

Type no.	EAN no.	D	H	H5	S	D2	Max Flow (l/s)
503.000.110	5705499118735	108	113	93	51	75	1.3

Accurate flow rate depending on type of drain and grating.

Water traps

**REMOVABLE WATER TRAP TYPE 503.001**

PREVENTS SMELL

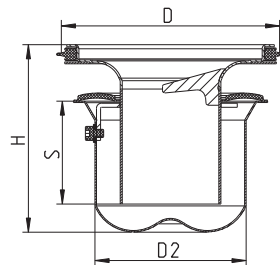

Type no.	EAN no.	D	H	S	D2	Max Flow (l/s)
503.001.110	5705499134728	108	93	51	75	1.3

Accurate flow rate depending on type of drain and grating.

**P-TRAP 87.5° TYPE 525**

WITH COUPLING AND DRAIN PLUG

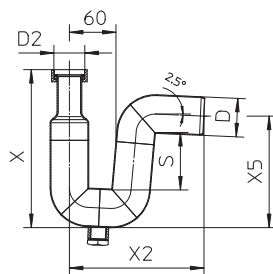

Type no.	EAN no.	D	S	D2	X	X2	X5
525.032.050 S	5705499114065	50	74	1 1/4"	205	175	145
525.040.050 S	5705499114072	50	74	1 1/2"	205	175	145
525.050.050 S	5705499114089	50	74	2"	205	175	145

BSP thread.

**P-TRAP 87.5° TYPE 525.090**

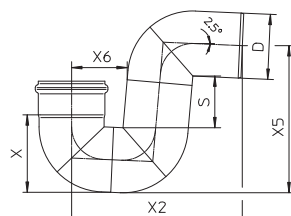

Type no.	EAN no.	D	S	X	X2	X5	X6	Max Flow (l/s)
525.090.050 S	5705499101461	50	74	67	175	145	60	1.7
525.090.075 S	5705499101478	75	81	93	222	189	74	2.5
525.090.110 S	5705499101485	110	89	132	289	249	94	3.4

Accurate flow rate depending on installation.



Water traps

S-TRAP 180° TYPE 525.180

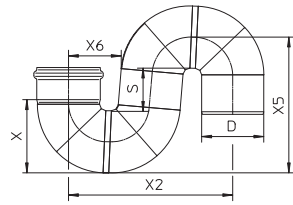

Type no.	EAN no.	D	S	X	X2	X5	X6
525.180.050 S	5705499114096	50	74	67	166	145	60
525.180.075 S	5705499114102	75	81	93	217	190	74
525.180.110 S	5705499114119	110	89	132	292	249	94

Others

**INTERMEDIATE SECTION TYPE 145**

WITH SIDE INLETS

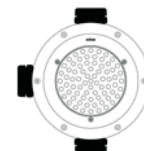
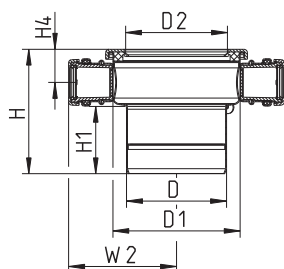

Type no.	EAN no.	D	D1	H	H1	H4	W 2	D2
145.300.110	5705499107197	110	140	137	75	37	119	113

**MOUNTING SET CIRCLE VIENNA**

WITH CLAMPING RING

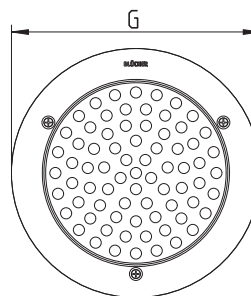
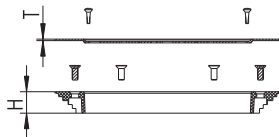

Type no.	EAN no.	G	H	T	Screws
620.300.002	5705499105629	Ø155	15	1	3

**FILTER BASKET FOR REMOVABLE TWO-PART WATER TRAP**

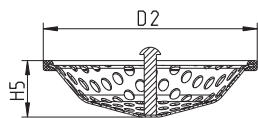

Type no.	EAN no.	H5	D2
502.000.000 S	5705499124101	24	106

Others

SCREEN FOR REMOVABLE WATER TRAP

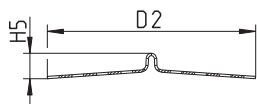
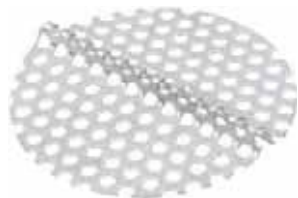

Type no.	EAN no.	H5	D2
501.000.000.05 S	5705499114003	10	90

Fits trap type 502.052

FLANGE FOR LIQUID MEMBRANE TYPE 326.300

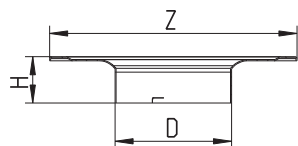

Type no.	EAN no.	D	Z	H
326.300.000	5705499107173	113	Ø240	45

FLANGE FOR LIQUID MEMBRANE, EXTRA LENGTH TYPE 326.300

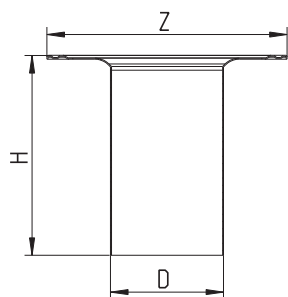

Type no.	EAN no.	D	Z	H
326.300.001	5705499107258	113	Ø240	200

Others

**FLANGE FOR LIQUID MEMBRANE TYPE 326.302**

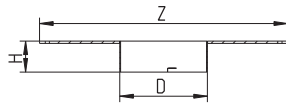

Type no.	EAN no.	D	Z	H
326.302.001	5705499131635	113	Ø320	40

**FLANGE FOR SHEET MEMBRANE**

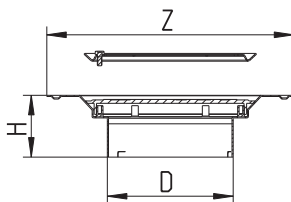

Type no.	EAN no.	D	Z	H
325.300.000	5705499107159	113	Ø222	56

**FLANGE AND GRATING FOR VINYL FLOORS (REPAIR)**

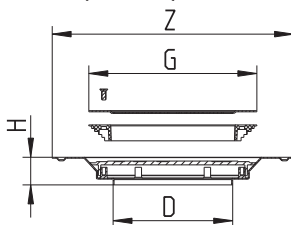

Type no.	EAN no.	D	Z	G	H
299.300.000	5705499107357	110	Ø222	Ø155	26

**FLANGE AND GRATING FOR VINYL FLOORS (REPAIR)**

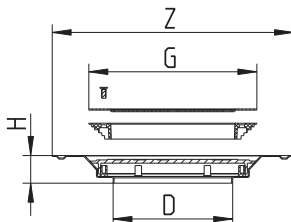

Type no.	EAN no.	D	Z	G	H
299.140.000	5705499100891	113	188x188	Ø136	28

Others

EXTENSION RING

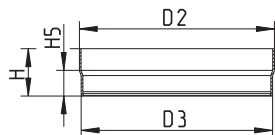

Type no.	EAN no.	H	H5	D2	D3
620.200.005 S	5705499105971	28	15	116	113
620.200.022 S	5705499127676	100	15	116	113

INSERT FOR CAST IRON SHOWER DRAIN, EXTRA LENGTH TYPE 130

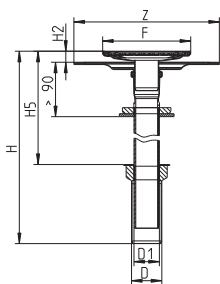

Type no.	EAN no.	D	D1	F	Z	H	H2	H5
130.155.040	5705499100150	50	42	145x145	Ø240	263-498	8-23	132-367

Fits D=75mm and D=82mm.

INSERT FOR SQUARE CAST IRON SHOWER DRAIN TYPE 135

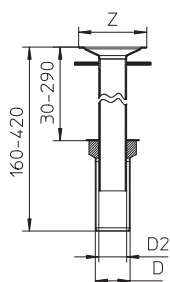

Type no.	EAN no.	D	Z	D2
135.000.040	5705499100167	50	Ø98	40

Fits D=75mm and D=82mm.

Others

**INSERT FOR ROUND CAST IRON SHOWER DRAIN TYPE 135**

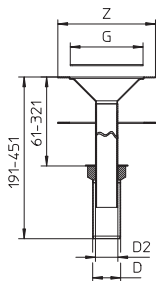

Type no.	EAN no.	D	Z	G	D2
135.130.040	5705499100174	50	Ø175	Ø130	40

Fits D=75mm and D=82mm.

**PLUG FOR SHOWER DRAIN**

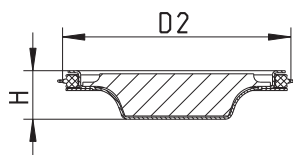

Type no.	EAN no.	H	D2
620.300.019 S	5705499118568	23	108

**CLAMPING RING**

FOR VINYL FLOORS OR FOR SHEET MEMBRANE

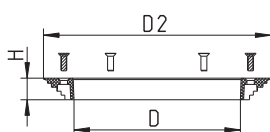

Type no.	EAN no.	D	H	D2
620.300.004	5705499105667	113	15	155

**ROSE**

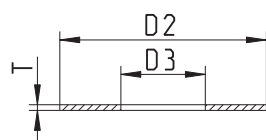

Type no.	EAN no.	D2	D3	T
620.300.013	5705499107821	110	45	3

Others

ADAPTOR TYPE 851

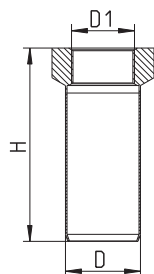

Type no.	EAN no.	D	D1	H
851.130.040	5705499403220	50	1 1/4"	130

D1 specified in inches ("). BSP thread.

SIDE INLET COMPLETE

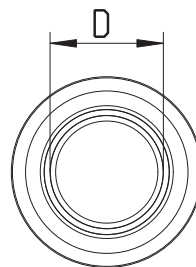

Type no.	EAN no.	D
620.300.008	5705499106695	32

Inlet diameter can be changed to D=40mm

SIDE INLET TYPE 880 (REPAIR)

FOR SHOWER DRAINS PRODUCED BEFORE 1998

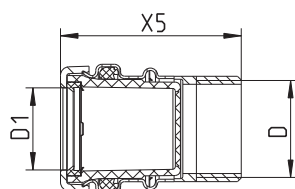

Type no.	EAN no.	D	D1	X5
880.032.000	5705499114331	1 1/4"	32	73

BSP thread.

Others

**DEFLECTOR**

FOR DRAINS WITH SIDE INLETS

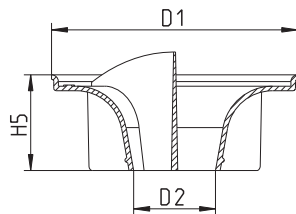

Type no.	EAN no.	D1	H5	D2
620.300.009	5705499106701	108	42	36

**SEALING RING**

FOR WATER TRAP TYPE 502.052.110

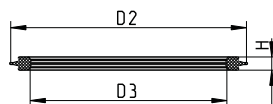

Type no.	EAN no.	H	D2	D3
620.300.010	5705499106718	6	110	50

**SEALING RING**

FOR WATER TRAP TYPE 502.050.110

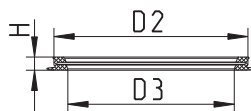

Type no.	EAN no.	H	D2	D3
620.300.042	5705499127331	7	102	87



Others

SET OF SCREWS



Type no.	EAN no.	Designation
620.300.007	5705499106688	Set of screws for grating (drain for concrete)
620.300.011	5705499102772	Set of screws for grating (drain for vinyl)
620.300.012	5705499106725	Set of screws for clamping ring

TAB BENDING TOOL

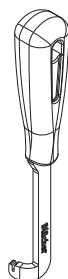

Type no.	EAN no.
001.000.001	5705499124088

VINYL CUTTING TEMPLATE  
FOR CUTTING IN VINYL FLOORS

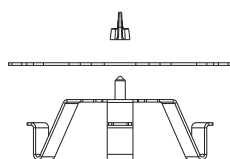

Type no.	EAN no.
001.200.001	5705499124095

Others

VINYL HOLE PUNCHING TOOL

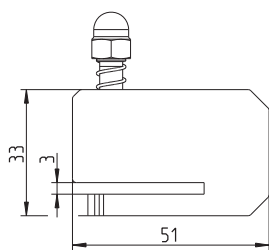

Type no.	EAN no.
001.200.002	5705499128239

MOUNTING PLATE

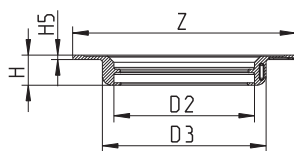

Type no.	EAN no.	Z	H	H5	D2	D3
620.300.039	5705499126976	250x250	34	5	158	184

## Shower channels for housing and commercial applications



### Height-adjustable No permanent connection between wall and floor

#### Applications

For tiled and vinyl flooring in:

- Private housing bathrooms
- Toilets and showers in hotels, hospitals, fitness centres, etc.

#### Details

- **NEW: One model for concrete/tiles can be installed with outlet left or right and against wall(s) or away from walls**
- 20 mm frame width
- 50 mm end outlet
- All in stainless steel AISI 304/EN 1.4301, brush finish
- Adjustable frame height
- Secured grate providing rat stop

#### Options

- OD40 mm outlet part without water trap
- OD75 mm water trap - horizontal or 45°
- Side inlet connection
- 6 different design gratings

#### Variants

- 300-700-800-900-1000 mm standard lengths
- Up to 2000 mm length as customized channel

#### Series

- Series 178 for tiled floors without membrane
- Series 275 for vinyl floors
- Series 378 for tiled floors with liquid membrane
- Series 398 for tiled floors with sheet membrane

## Complete drains

Series 178 for tiled floor without membrane



Series 275 for vinyl floor



Series 378 for tiled floor with liquid membrane



Series 398 for tiled floor with sheet membrane

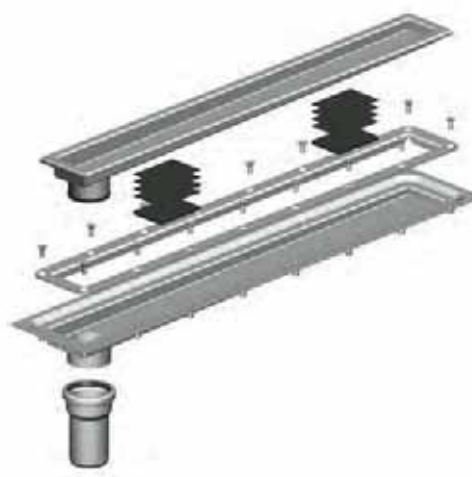

### Complete shower channel

#### Channel

Series 178 1-part channel or series 275, 378 and 398 adjustable 2-part shower channel. Standard OD50 mm end outlet included.

Series 378 and 398 come with rubber pads for height adjustment.

Series 378 comes with removable mounting brackets.

#### Grating

No standard grating is included - selected design grating to be ordered separately.

#### Water trap

Water trap with casing and stand pipe not included - to be ordered separately. To be fitted during installation of the channel, cannot be retro-fitted.

Side inlet OD40 mm is an accessory - to be ordered separately.



## Installation examples

### Tiles



### Tiles and liquid membrane

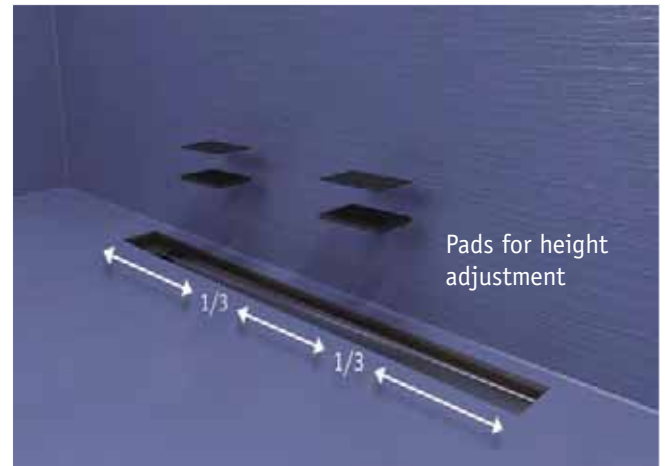

### Vinyl

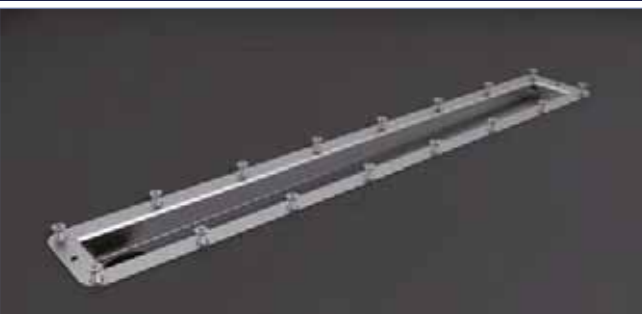

Installation videos available at [www.blucher.com](http://www.blucher.com)

without membrane

**SHOWER CHANNEL WATERLINE TYPE 178**

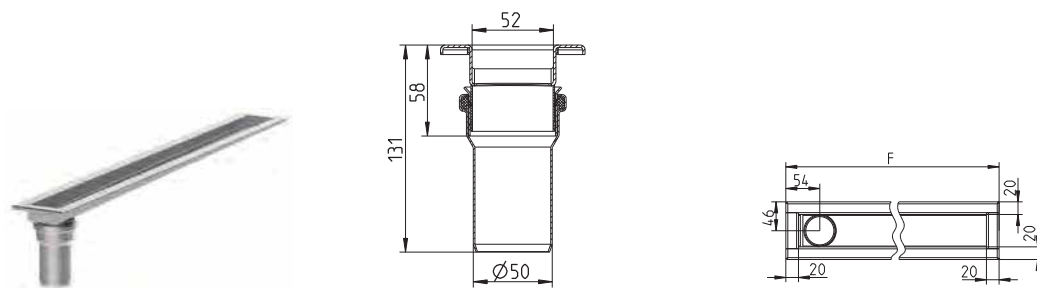

Type no.	EAN no.	Name	F
178.030.056.20	5705499138108	300	274
178.070.056.20	5705499138429	700	674
178.080.056.20	5705499138115	800	774
178.090.056.20	5705499138122	900	874
178.100.056.20	5705499138139	1000	974

**SHOWER CHANNEL WATERLINE TYPE 178, ITEM SET**

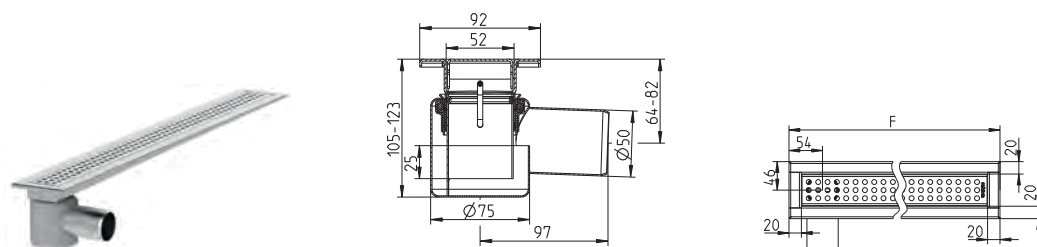

Type no.	EAN no.	Name	F
178.070.056.7A	5705499138306	700	674
178.080.056.7A	5705499138313	800	774
178.090.056.7A	5705499138320	900	874
178.100.056.7A	5705499138337	1000	974

Complete with shower channel, lower part, grating and water trap.

with liquid membrane

## SHOWER CHANNEL WATERLINE TYPE 378

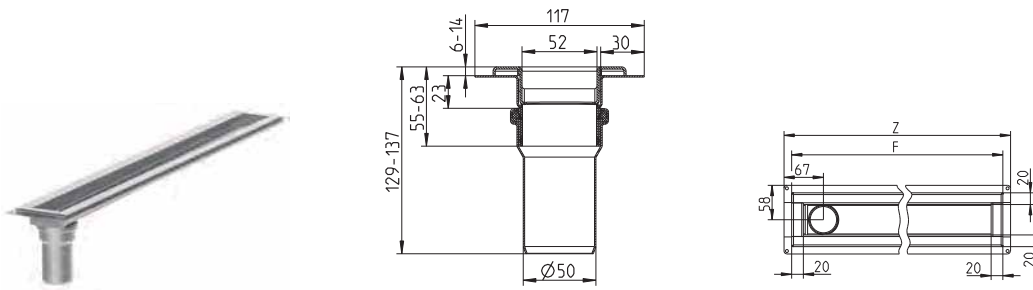

Type no.	EAN no.	Name	F	Z
378.030.056.20	5705499138368	300	274	300
378.070.056.20	5705499138146	700	674	700
378.080.056.20	5705499138153	800	774	800
378.090.056.20	5705499138160	900	874	900
378.100.056.20	5705499138177	1000	974	1000

## SHOWER CHANNEL WATERLINE TYPE 378, ITEM SET

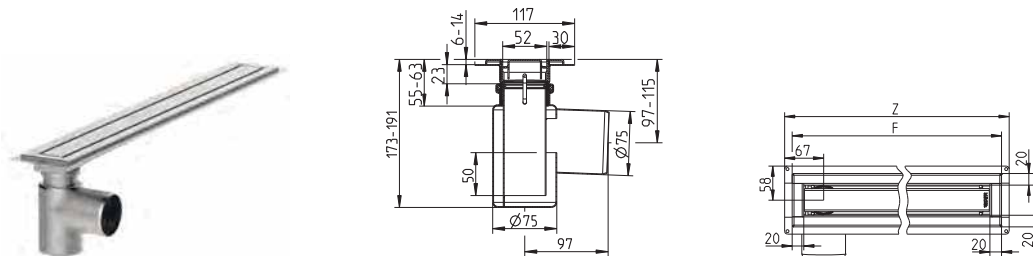

Type no.	EAN no.	Name	F	Z
378.070.056.4B	5705499138184	700	674	700
378.080.056.4B	5705499138191	800	774	800
378.090.056.4B	5705499138207	900	874	900
378.100.056.4B	5705499138214	1000	974	1000

Complete with shower channel, lower part, grating and water trap.

## SHOWER CHANNEL WATERLINE TYPE 378, ITEM SET

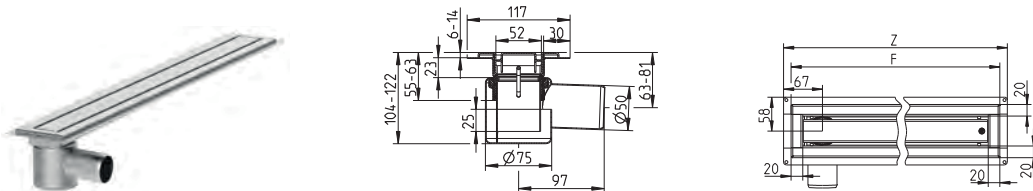

Type no.	EAN no.	Name	F	Z
378.080.056.7B	5705499138344	800	774	800
378.090.056.7B	5705499138351	900	874	900

Complete with shower channel, lower part, grating and water trap.

with sheet membrane

**SHOWER CHANNEL WATERLINE TYPE 398**

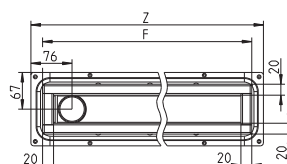
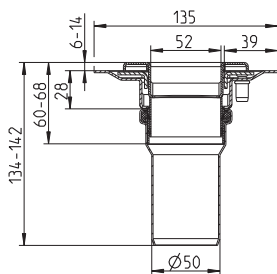

Type no.	EAN no.	Name	F	Z
398.070.056.20	5705499138375	700	674	717
398.080.056.20	5705499138382	800	774	817
398.090.056.20	5705499138399	900	874	917
398.100.056.20	5705499138412	1000	974	1017



SHOWER CHANNEL WATERLINE TYPE 275

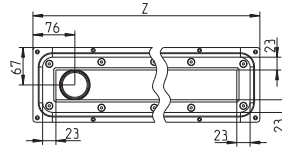
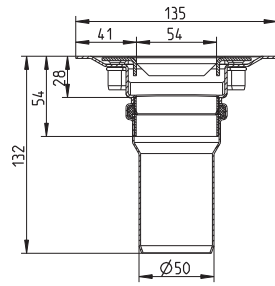

Type no.	EAN no.	Name	Z
275.070.056.20	5705499122527	700	717
275.080.056.20	5705499122534	800	817
275.090.056.20	5705499122541	900	917
275.100.056.20	5705499122558	1000	1017

Required distance from wall to long side of channel = 50mm  
 Required distance from wall to end of channel = 100mm

Gratings

GRATING LINE ATHENS

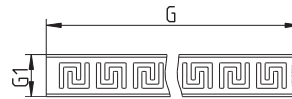
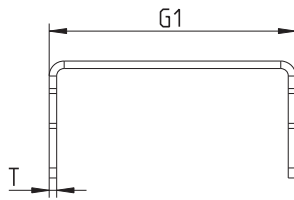
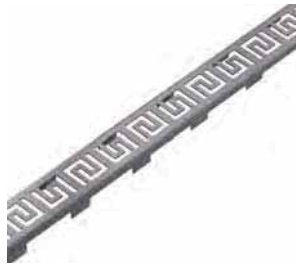

Type no.	EAN no.	G	G1	T	Max Flow (l/s)
697.005.030	5705499122794	232	50	1.5	0.7
697.005.070	5705499122800	632	50	1.5	0.9
697.005.080	5705499122817	732	50	1.5	0.9
697.005.090	5705499122824	832	50	1.5	0.9
697.005.100	5705499122831	932	50	1.5	0.9

If used with water trap type 510, please note that max flow through water trap is 0.8 l/s.

GRATING LINE COPENHAGEN

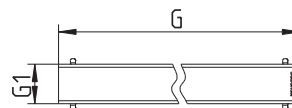
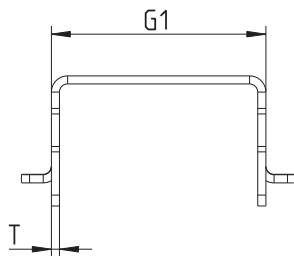

Type no.	EAN no.	G	G1	T	Max Flow (l/s)
697.004.030	5705499119251	232	40	1.5	0.9
697.004.070	5705499119268	632	40	1.5	1.1
697.004.080	5705499119275	732	40	1.5	1.1
697.004.090	5705499119282	832	40	1.5	1.1
697.004.100	5705499119299	932	40	1.5	1.1

If used with water trap type 510, please note that max flow through water trap is 0.8 l/s.

GRATING LINE DETROIT

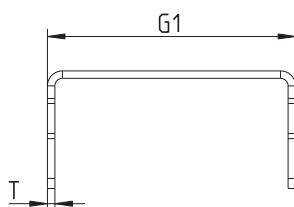

Type no.	EAN no.	G	G1	T	Max Flow (l/s)
697.006.030	5705499122862	232	50	1.5	0.6
697.006.070	5705499122879	632	50	1.5	0.7
697.006.080	5705499122886	732	50	1.5	0.7
697.006.090	5705499122893	832	50	1.5	0.7
697.006.100	5705499122909	932	50	1.5	0.7

## Gratings

### GRATING LINE OSLO

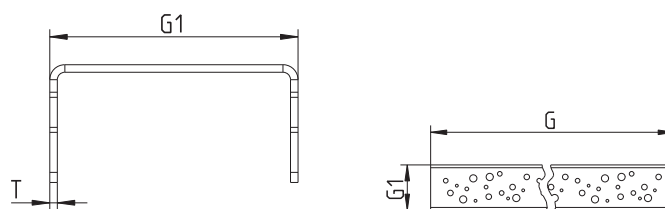

Type no.	EAN no.	G	G1	T	Max Flow (l/s)
697.008.030	5705499122725	232	50	1.5	0.4
697.008.070	5705499122732	632	50	1.5	0.5
697.008.080	5705499122749	732	50	1.5	0.5
697.008.090	5705499122756	832	50	1.5	0.5
697.008.100	5705499122763	932	50	1.5	0.5

### GRATING LINE VIENNA

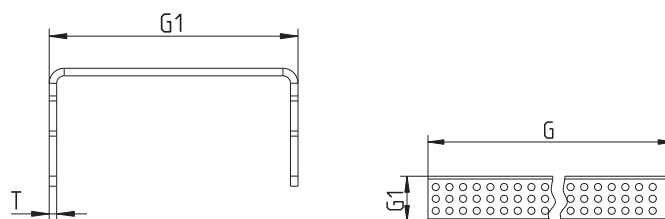

Type no.	EAN no.	G	G1	T	Max Flow (l/s)
697.003.030	5705499119206	232	50	1.5	0.7
697.003.070	5705499119213	632	50	1.5	0.9
697.003.080	5705499119220	732	50	1.5	0.9
697.003.090	5705499119237	832	50	1.5	0.9
697.003.100	5705499119244	932	50	1.5	0.9

If used with water trap type 510, please note that max flow through water trap is 0.8 l/s.

### GRATING LINE TOKYO

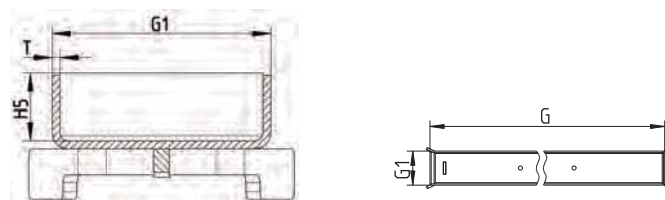

Type no.	EAN no.	G	G1	H5	T	Max Flow (l/s)
697.009.030	5705499126983	224	42	13	1.5	0.8
697.009.070	5705499126990	624	42	13	1.5	0.8
697.009.080	5705499127003	724	42	13	1.5	0.8
697.009.090	5705499127010	824	42	13	1.5	0.8
697.009.100	5705499127027	924	42	13	1.5	0.8

Gratings

**GRATING LINE COPENHAGEN VINYL**

FOR WATERLINE SHOWER CHANNEL FOR VINYL FLOORS

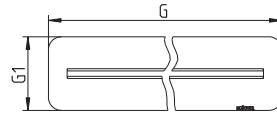
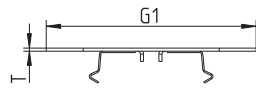

Type no.	EAN no.	G	G1	T	Max Flow (l/s)
697.104.070	5705499122565	685	103	1.5	0.6
697.104.080	5705499122572	785	103	1.5	0.6
697.104.090	5705499122589	885	103	1.5	0.6
697.104.100	5705499122596	985	103	1.5	0.6

## Water traps

### WATER TRAP FOR WATERLINE

TO BE BUILT IN - CANNOT BE RETRO-FITTED

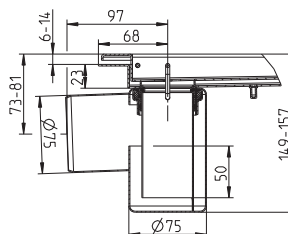
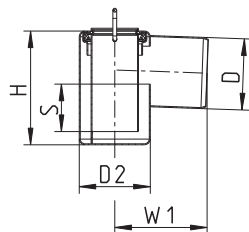

Type no.	EAN no.	D	H	S	W1	D2	Max Flow (l/s)
510.000.075	5705499120011	75	120	50	97	75	0.8

Accurate flow rate depending on type of grating.

### WATER TRAP FOR WATERLINE, HIGH MODEL

TO BE BUILT IN - CANNOT BE RETRO-FITTED

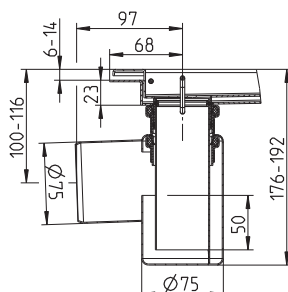
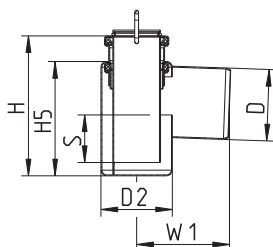

Type no.	EAN no.	D	H	H5	S	W1	D2	Max Flow (l/s)
510.002.075	5705499123067	75	147	120	50	97	75	0.8

Accurate flow rate depending on type of grating.

### WATER TRAP 45° FOR WATERLINE

TO BE BUILT IN - CANNOT BE RETRO-FITTED

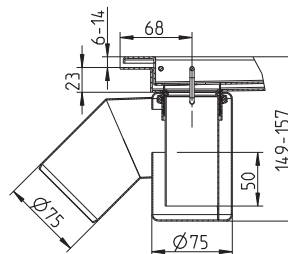
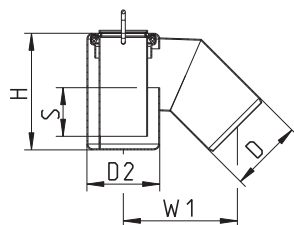

Type no.	EAN no.	D	H	S	W1	D2	Max Flow (l/s)
510.003.075	5705499123074	75	120	50	117	75	0.8

Accurate flow rate depending on type of grating.

Water traps

**WATER TRAP FOR WATERLINE, LOW MODEL**

TO BE BUILT IN - CANNOT BE RETRO-FITTED

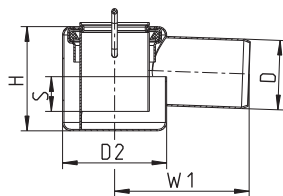

Type no.	EAN no.	D	H	S	W1	D2
510.025.050	5705499134711	50	75	25	97	75

**P-TRAP 87.5° TYPE 525.090**

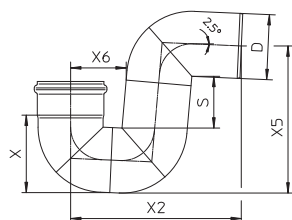

Type no.	EAN no.	D	S	X	X2	X5	X6	Max Flow (l/s)
525.090.050 S	5705499101461	50	74	67	175	145	60	1.7

Accurate flow rate depending on installation.

Others

FLANGE FOR WATERLINE

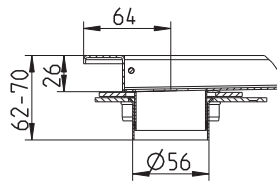
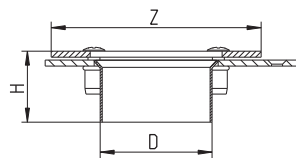

Type no.	EAN no.	D	Z	H
326.005.000	5705499121513	56	105x105	36

LOWER PART FOR WATERLINE

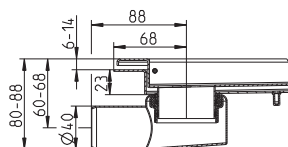
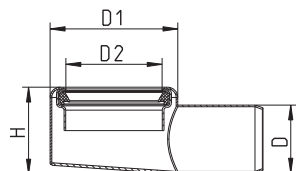

Type no.	EAN no.	D	D1	H	D2
620.300.028	5705499120288	40	75	51	56

STAND PIPE FOR WATERLINE WATER TRAP

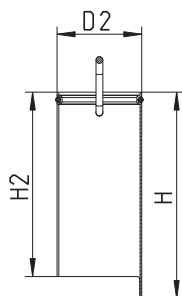

Type no.	EAN no.	H	H2	D2
620.300.021	5705499120035	122	109	50

Others

**CONNECTING PIECE FOR WATERLINE  
WITH SIDE INLET**

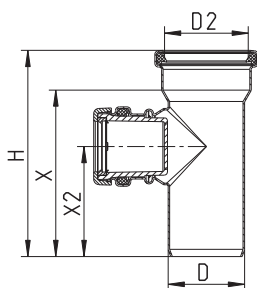

Type no.	EAN no.	D	H	D2	X	X2
620.300.036	5705499123692	50	135	56	109	72

Side inlet  $\varnothing 32\text{mm}$  fits  $\varnothing 40\text{mm}$  as well.

**CONNECTING PIECE FOR WATERLINE**

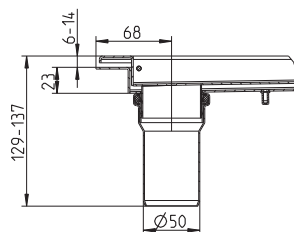
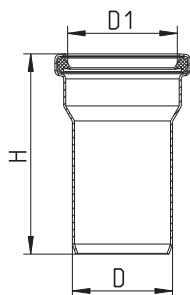

Type no.	EAN no.	D	D1	H
620.300.022	5705499120042	50	56	100

**CONNECTING PIECE FOR WATERLINE  
FOR TYPE 17X**

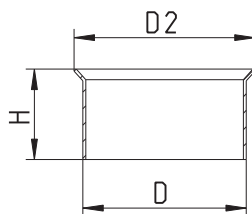

Type no.	EAN no.	D	H	D2
620.300.023	5705499120059	56	31	62



Others

**MOUNTING BRACKETS FOR WATERLINE**

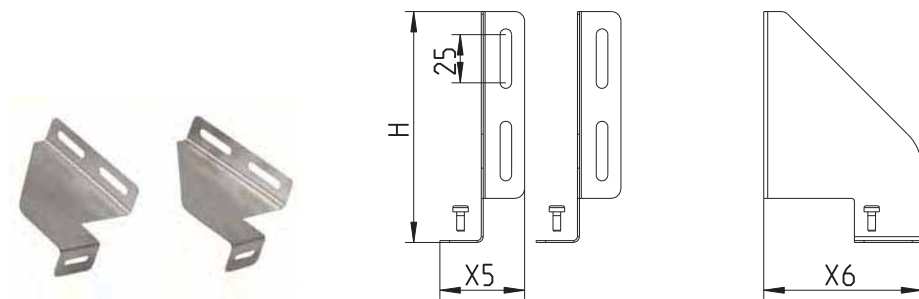

Type no.	EAN no.	H	X5	X6
620.300.037	5705499123814	120	44	82

**MOUNTING SET FOR WATERLINE**

FOR WOODEN SUBFLOOR

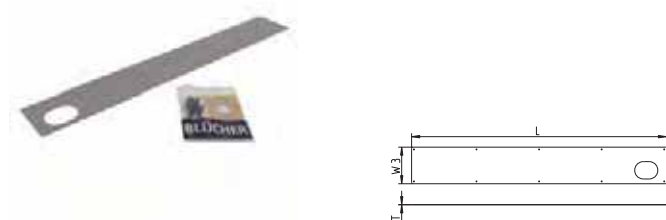

Type no.	EAN no.	L	W3	T
379.011.000	5705499127836	1100	158	0.7

# Pipes and fittings for commercial and industrial applications



Push-fit system  
 Lightweight  
 Fire resistant

## Applications

- Above or below ground
- Completely interchangeable between vacuum and gravity systems

## Details

- Standard dimensions  $\varnothing 40$  -  $\varnothing 315$ mm
- Standard lengths 0.15 - 6 metres
- Extensive range of fittings
- Sealing ring included (one sealing ring for gravity and vacuum)
- Stainless steel AISI304/EN 1.4301 or AISI316L/EN 1.4404

## Variants

- Range of sealing rings for various applications

## Options

- Range of pipe hangers
- Access pipe with hinged door
- Rat stop
- Electrical or manual pipe cutters

## Complete systems

BLÜCHER® EuroPipe system can be used for many purposes - waste-water drainage, rainwater drainage, vacuum-cleaning systems, roof drainage

Waste-water drainage system, gravity

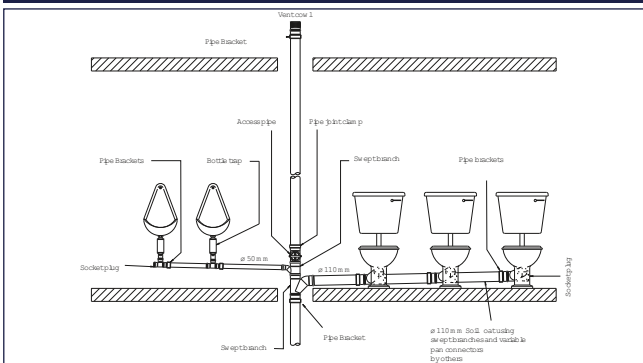

Waste-water drainage system, vacuum

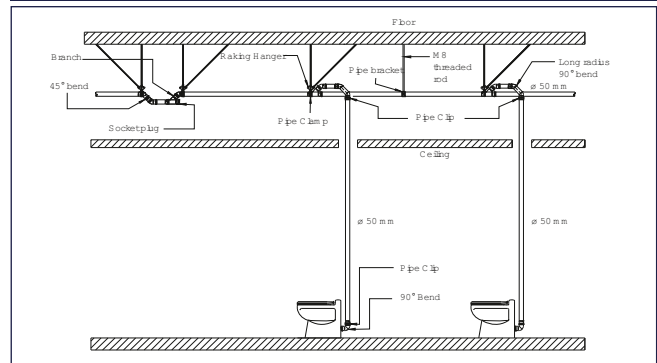

Below ground installation

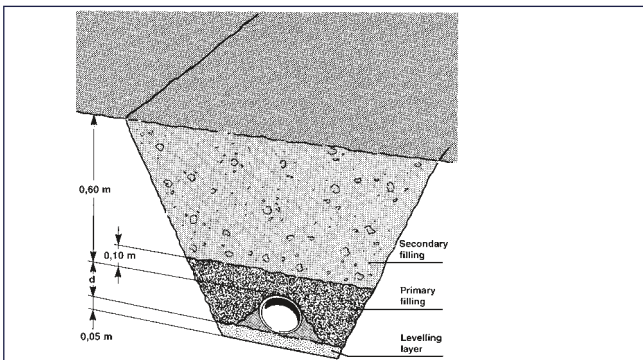

Below ground, pipes cast in raft foundation

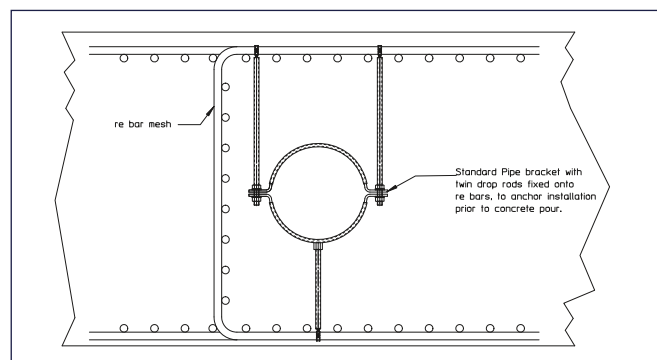

Siphonic rainwater installation

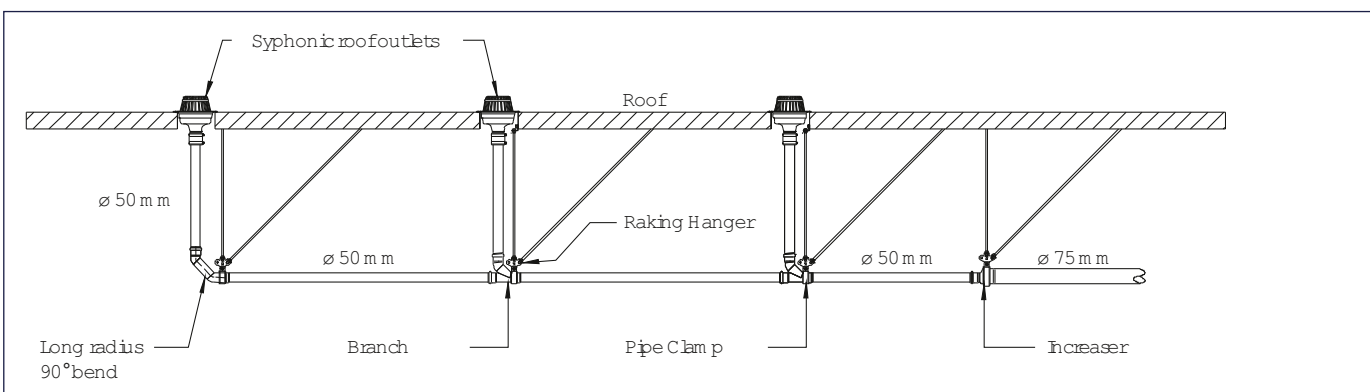

## Installation examples

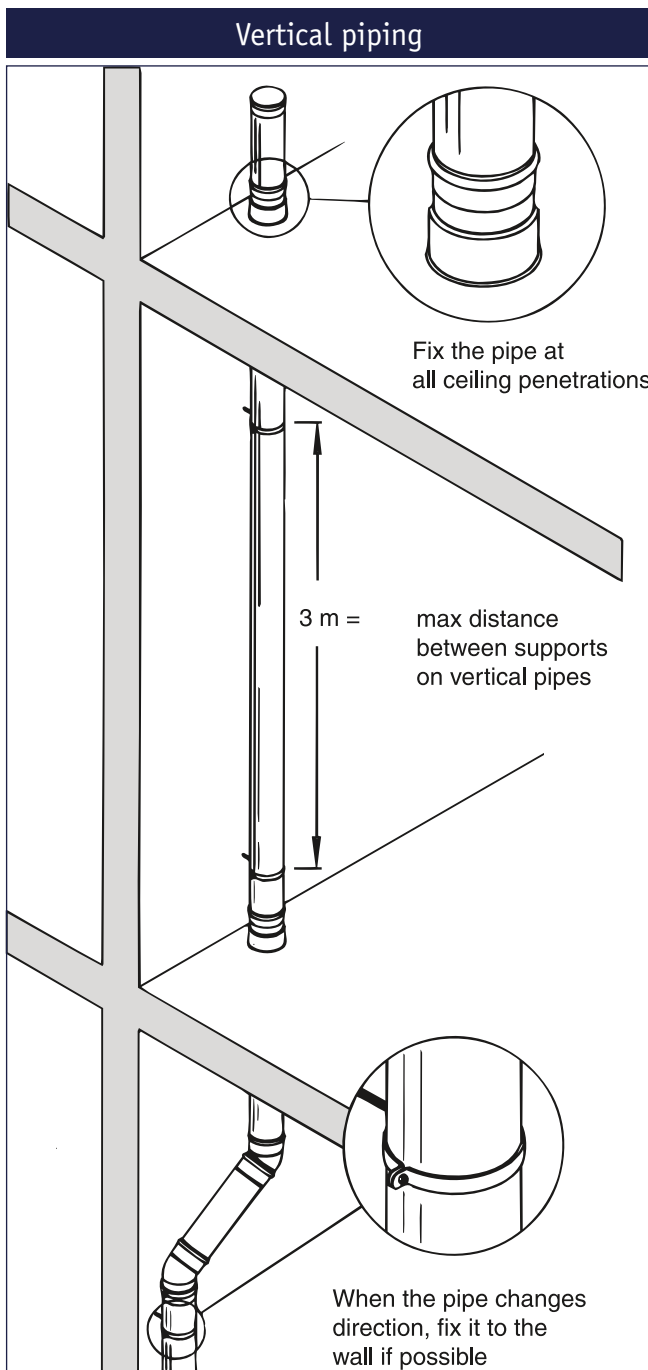

One fixing point per storey is normally sufficient. As opposed to plastic pipes, stainless steel pipes require only one pipe hanger per 3 metres, resulting in less sound and faster installation.

**For further specifications and installation advice see the catalogue: "Technical information on BLÜCHER® EuroPipe".**

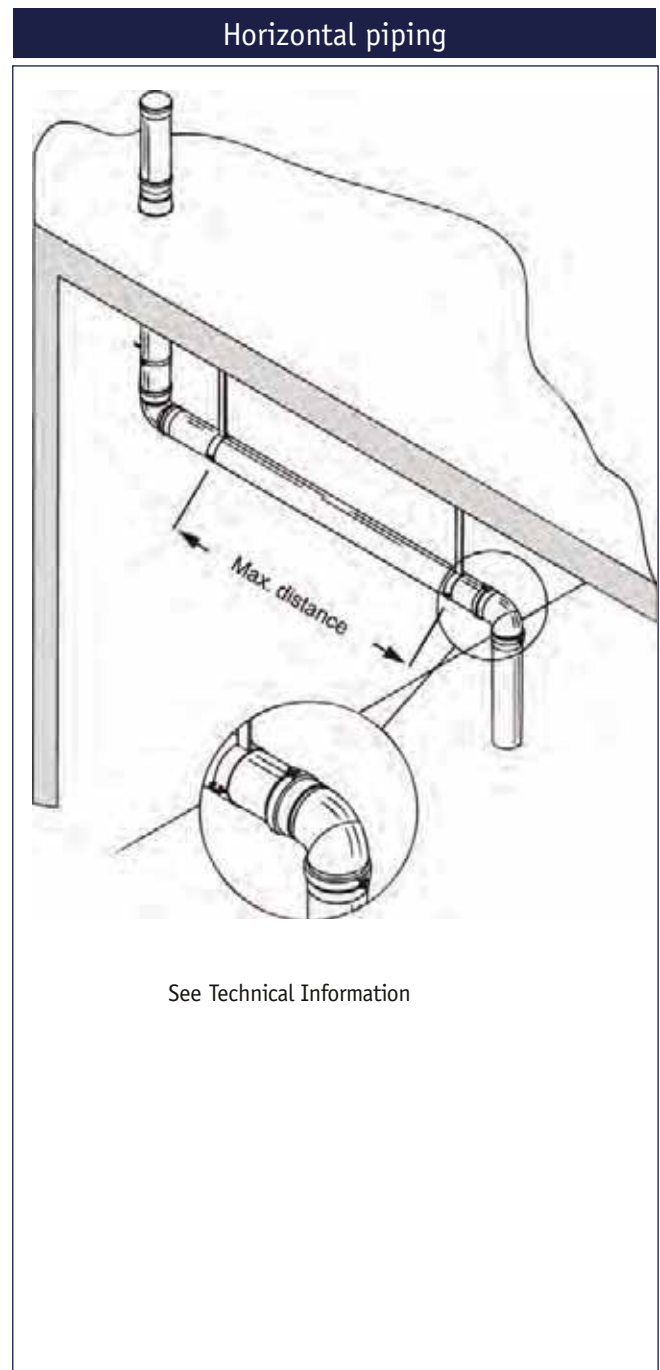

Horizontal pipe runs are always to be installed with a gradient. If no self-cleansing calculation is available, a gradient of 20 ‰ is recommended in gravity systems. Horizontal pipe runs in vacuum systems are to be installed in accordance with the recommendations of the vacuum system supplier.

When connecting major branch lines, the pipe is to be fixed just below the branch line.

## DIMENSIONAL DRAWING, SOCKET AND SPIGOT END

## PIPES AND FITTINGS

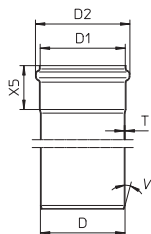

Type no.	EAN no.	D	D1	D2	X5	T	V (°)
811.XXX.040		40	41	52	41	1	20
811.XXX.050		50	51	61	42	1	20
811.XXX.075		75	76	87	50	1	20
811.XXX.082		82	83	94	52	1	20
811.XXX.110		110	111	123	57	1	20
811.XXX.125		125	126	140	60	1	20
811.XXX.160		160	161	177	72	1.25	20
811.XXX.200		200	201	219	90	1.5	20
811.XXX.250		250	251	277	108	1.5	20
811.XXX.315		315	316	344	116	2	20

## STRAIGHT PIPE WITH ONE SOCKET TYPE 811

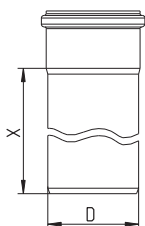

Type no.	EAN no.	D	X	Kg
811.015.040	5705499412635	40	150	0,20
811.025.040	5705499412659	40	250	0,40
811.050.040	5705499412673	40	500	0,60
811.075.040	5705499412697	40	750	0,78
811.100.040	5705499412710	40	1000	1,02
811.150.040	5705499412734	40	1500	1,50
811.200.040	5705499412758	40	2000	1,99
811.300.040	5705499412772	40	3000	2,96
811.400.040	5705499412796	40	4000	3,92
811.500.040	5705499412819	40	5000	4,89
811.600.040	5705499412833	40	6000	5,86
-----				
811.015.050	5705499400205	50	150	0,25
811.025.050	5705499400281	50	250	0,38
811.050.050	5705499400366	50	500	0,68
811.075.050	5705499400441	50	750	1,00
811.100.050	5705499400526	50	1000	1,25
811.150.050	5705499400601	50	1500	1,90
811.200.050	5705499400687	50	2000	2,45
811.300.050	5705499400762	50	3000	3,82
811.400.050	5705499400854	50	4000	5,06
811.500.050	5705499400939	50	5000	6,31
811.600.050	5705499401011	50	6000	7,56
-----				
811.015.075	5705499400229	75	150	0,41
811.025.075	5705499400304	75	250	0,58
811.050.075	5705499400380	75	500	1,00
811.075.075	5705499400465	75	750	1,50
811.100.075	5705499400540	75	1000	1,95
811.150.075	5705499400625	75	1500	2,75
811.200.075	5705499400700	75	2000	3,70
811.300.075	5705499400793	75	3000	5,78
811.400.075	5705499400878	75	4000	7,66
811.500.075	5705499400953	75	5000	9,54
811.600.075	5705499401035	75	6000	11,42
-----				
811.015.082	5705499411591	82	150	0,44
811.025.082	5705499411614	82	250	0,64
811.050.082	5705499411638	82	500	1,14
811.075.082	5705499411652	82	750	1,65
811.100.082	5705499411676	82	1000	2,15
811.150.082	5705499411690	82	1500	3,16
811.200.082	5705499411713	82	2000	4,17
811.300.082	5705499411737	82	3000	6,20
811.400.082	5705499411751	82	4000	8,22
811.500.082	5705499411775	82	5000	10,24
811.600.082	5705499411799	82	6000	12,26
-----				
811.015.110	5705499400243	110	150	0,61
811.025.110	5705499400328	110	250	0,87
811.050.110	5705499400403	110	500	1,50
811.075.110	5705499400489	110	750	2,15
811.100.110	5705499400564	110	1000	2,85
811.150.110	5705499400649	110	1500	4,30

Continues on next page

## STRAIGHT PIPE WITH ONE SOCKET TYPE 811

Type no.	EAN no.	D	X	Kg
Continued from previous page				
811.200.110	5705499400724	110	2000	5,40
811.300.110	5705499400816	110	3000	8,34
811.400.110	5705499400892	110	4000	11,26
811.500.110	5705499400977	110	5000	14,02
811.600.110	5705499401059	110	6000	16,78
-----				
811.015.125	5705499410839	125	150	0,70
811.025.125	5705499408218	125	250	1,01
811.050.125	5705499408232	125	500	1,78
811.075.125	5705499410860	125	750	2,55
811.100.125	5705499408263	125	1000	3,32
811.150.125	5705499408287	125	1500	4,86
811.200.125	5705499408300	125	2000	6,40
811.300.125	5705499410907	125	3000	9,47
811.400.125	5705499410914	125	4000	12,55
811.500.125	5705499410938	125	5000	15,63
811.600.125	5705499410952	125	6000	18,71
-----				
811.015.160	5705499400267	160	150	1,19
811.025.160	5705499400342	160	250	1,69
811.050.160	5705499400427	160	500	2,96
811.075.160	5705499400502	160	750	4,22
811.100.160	5705499400588	160	1000	5,48
811.150.160	5705499400663	160	1500	8,02
811.200.160	5705499400748	160	2000	10,54
811.300.160	5705499400830	160	3000	15,59
811.400.160	5705499400915	160	4000	20,64
811.500.160	5705499400991	160	5000	25,69
811.600.160	5705499401073	160	6000	30,74
-----				
811.015.200	5705499412291	200	150	1,96
811.025.200	5705499412307	200	250	2,77
811.050.200	5705499412314	200	500	4,62
811.075.200	5705499412321	200	750	6,47
811.100.200	5705499412338	200	1000	8,32
811.200.200	5705499412345	200	2000	15,71
811.300.200	5705499412352	200	3000	23,10
-----				
811.050.250	5705499121735	250	500	5,84
811.100.250	5705499121742	250	1000	10,47
811.200.250	5705499121759	250	2000	19,72
811.300.250	5705499121766	250	3000	28,97
-----				
811.050.315 S	5705499413748	315	500	9,93
811.100.315 S	5705499413762	315	1000	17,70
811.200.315 S	5705499413786	315	1867	33,24
811.300.315 S	5705499413809	315	3000	48,77

## PIPE WITH ACCESS TYPE 813

IMPACT RESISTANT

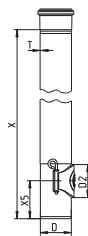

Type no.	EAN no.	D	D2	X	X5	T
813.150.075	5705499413557	75	80	1500	92	2
813.150.110	5705499413540	110	120	1500	123	2

For non pressurized system

- Bends

**BEND 15° TYPE 820.015**

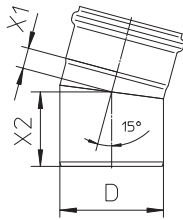

Type no.	EAN no.	D	X1	X2	Kg
820.015.040	5705499412857	40	15	53	0,12
820.015.050	5705499401127	50	19	53	0,15
820.015.075	5705499401141	75	21	65	0,28
820.015.082	5705499411812	82	17	64	0,30
820.015.110	5705499401165	110	25	78	0,47
820.015.125	5705499408607	125	19	84	0,56
820.015.160	5705499401189	160	29	99	1,08
820.015.200 S	5705499410976	200	31	123	1,99
820.015.250 S	5705499121599	250	38	136	3,03
820.015.315 S	5705499413816	315	46	151	5,50

**BEND 20° TYPE 820.020**

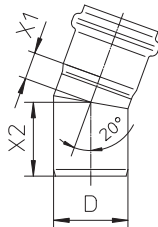

Type no.	EAN no.	D	X1	X2	Kg
820.020.050	5705499401202	50	18	50	0,15

**BEND 22.5° TYPE 820.023**

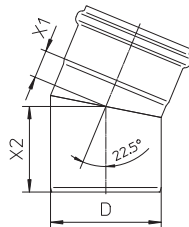

Type no.	EAN no.	D	X1	X2	Kg
820.023.050 S	5705499408621	50	15	57	0,15
820.023.075 S	5705499401219	75	21	71	0,29
820.023.110 S	5705499408638	110	28	85	0,51
820.023.160 S	5705499408645	160	39	109	1,18

**BEND 30° TYPE 820.030**

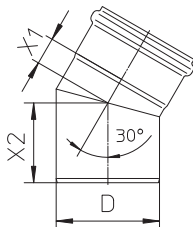

Type no.	EAN no.	D	X1	X2	Kg
820.030.040	5705499412871	40	18	55	0,13
820.030.050	5705499401226	50	23	57	0,16
820.030.075	5705499401240	75	25	70	0,28
820.030.082	5705499411836	82	23	70	0,32
820.030.110	5705499401264	110	33	86	0,51
820.030.125	5705499408652	125	28	98	0,63
820.030.160	5705499401288	160	40	110	1,19
820.030.200 S	5705499410983	200	45	137	2,20
820.030.250 S	5705499121605	250	56	153	3,35
820.030.315 S	5705499413823	315	68	172	6,18

- Bends

**BEND 45° TYPE 820.045**

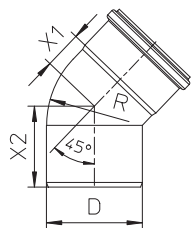

Type no.	EAN no.	D	X1	X2	R	Kg
820.045.040	5705499412895	40	21	58	40	0,13
820.045.050	5705499401301	50	27	60	50	0,17
820.045.075	5705499401325	75	34	76	75	0,30
820.045.082	5705499411850	82	30	80	82	0,34
820.045.110	5705499401349	110	43	93	110	0,56
820.045.125	5705499408676	125	58	111	125	0,73
820.045.160	5705499401363	160	57	128	172	1,55
820.045.200 S	5705499414011	200	61	151	200	2,38

**BEND 68° TYPE 820.068**

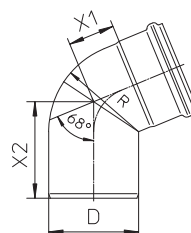

Type no.	EAN no.	D	X1	X2	R	Kg
820.068.082	5705499412369	82	41	97	82	0,40
820.068.110	5705499403817	110	57	118	110	0,60

**BEND 87.5° TYPE 820.090**

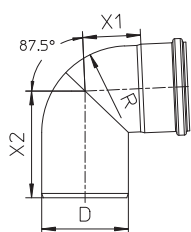

Type no.	EAN no.	D	X1	X2	R	Kg
820.090.040	5705499412918	40	32	79	40	0,16
820.090.050	5705499401387	50	41	87	50	0,21
820.090.075	5705499401400	75	54	108	75	0,39
820.090.082	5705499411874	82	53	109	82	0,43
820.090.110	5705499401424	110	74	136	110	0,67
820.090.125	5705499408720	125	93	161	125	1,68
820.090.160	5705499401448	160	103	184	171	2,10
820.090.200 S	5705499414042	200	116	216	200	3,00

To comply with BS EN 12056 Gravity Drainage inside Buildings use 821 bend at offsets and base of stack.

**BEND, LONG RADIUS 87.5°, 50 MM TYPE 821.000**

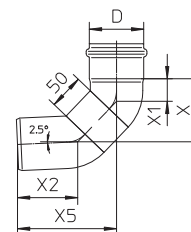

Type no.	EAN no.	D	X	X1	X2	X5	Kg
821.000.050	5705499404005	50	77	26	72	120	0,30
821.000.075	5705499404029	75	90	32	86	141	0,50



- Bends

**BEND, LONG RADIUS 87.5°, 164 MM TYPE 821.164**

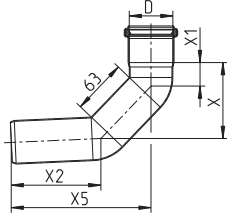

Type no.	EAN no.	D	X	X1	X2	X5	Kg
821.164.050 S	5705499124057	50	87	27	103	160	0,32

**BEND, LONG RADIUS 87.5°, 250 MM TYPE 821.090**

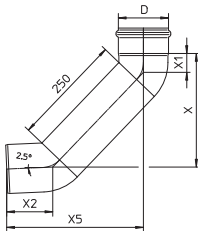

Type no.	EAN no.	D	X	X1	X2	X5	Kg
821.090.050	5705499408751	50	221	26	72	259	0,50
821.090.075	5705499408775	75	234	32	87	280	0,90
821.090.110	5705499401462	110	255	42	103	307	1,61
821.090.125	5705499412178	125	275	58	126	335	1,72
821.090.160	5705499401486	160	285	56	137	356	3,25

**BEND, LARGE RADIUS 45° TYPE 825.045**

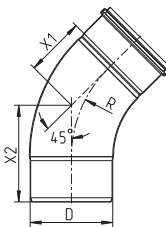

Type no.	EAN no.	D	X1	X2	R	Kg
825.045.200 S	5705499410990	200	144	234	300	4,18
825.045.250 S	5705499121612	250	187	280	375	6,53
825.045.315 S	5705499413830	315	204	320	400	10,78

**BEND, LARGE RADIUS 87.5° TYPE 825.090**

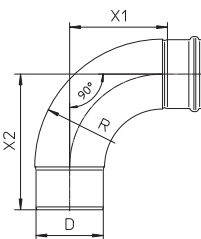

Type no.	EAN no.	D	X1	X2	R	Kg
825.090.050 S	5705499408843	50	77	125	97	0,65
825.090.075 S	5705499408850	75	104	155	133	1,00
825.090.110 S	5705499408867	110	160	222	209	1,41
825.090.160 S	5705499408874	160	244	322	313	2,99
825.090.200 S	5705499411423	200	307	397	300	6,41
825.090.250 S	5705499121629	250	391	484	375	9,88
825.090.315 S	5705499413847	315	421	538	400	15,78

To comply with BS EN 12056 Gravity Drainage inside Buildings use 821 bend at offsets and base of stack.

- Branches

BRANCH 67.5° TYPE 829

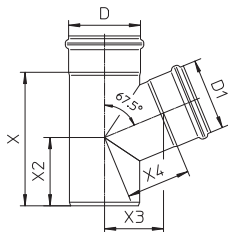

Type no.	EAN no.	D	D1	X	X2	X3	X4	Kg
829.050.075	5705499401585	75	50	139	80	64	70	1,00
829.050.082	5705499411898	82	50	133	73	67	72	0,50
829.075.075	5705499401592	75	75	150	80	73	79	0,53
829.075.082	5705499411904	82	75	160	87	64	71	0,62
829.082.082	5705499411911	82	82	168	91	67	72	0,66
829.110.110	5705499403824	110	110	209	107	92	100	0,88

BRANCH 87.5° TYPE 830

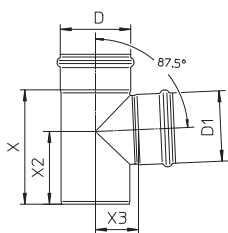

Type no.	EAN no.	D	D1	X	X2	X3	Kg
830.040.040	5705499412932	40	40	101	69	30	0,22
830.040.050	5705499412956	50	40	106	71	35	0,26
830.050.050	5705499401608	50	50	106	71	35	0,27
830.050.075	5705499401622	75	50	139	98	49	0,44
830.050.082	5705499411928	82	50	128	86	52	0,47
830.050.110	5705499401646	110	50	132	93	66	0,64
830.050.160	5705499401660	160	50	158	109	88	2,40
830.075.075	5705499401684	75	75	139	90	52	0,50
830.075.082	5705499411942	82	75	154	99	55	0,57
830.075.110	5705499401707	110	75	152	104	69	0,76
830.075.125	5705499408942	125	75	187	110	77	0,94
830.075.160	5705499412550	160	75	179	121	95	1,46
830.082.082	5705499411966	82	82	162	103	56	0,61
830.110.110	5705499401721	110	110	183	117	69	0,88
830.110.125	5705499408973	125	110	205	127	77	1,25
830.110.160	5705499401745	160	110	236	152	93	1,84
830.125.125	5705499409000	125	125	220	135	82	1,17
830.160.160	5705499401769	160	160	288	184	104	2,40
830.160.200 S	5705499411003	200	160	293	186	125	3,45
830.200.200 S	5705499411010	200	200	333	206	128	4,17
830.200.250 S	57054994121636	250	200	352	220	155	5,50
830.250.250 S	57054994121643	250	250	407	245	152	6,53
830.250.315 S	5705499413854	315	250	416	253	189	9,95
830.315.315 S	5705499413861	315	315	481	286	196	12,22

To comply with BS EN 12056 Gravity Drainage inside Buildings, when using non reducing branch consider branch type 838, 848 or 839

DOUBLE BRANCH 87.5° TYPE 831

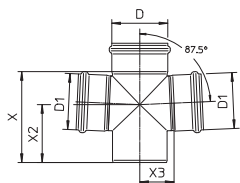

Type no.	EAN no.	D	D1	X	X2	X3	Kg
831.050.050	5705499401783	50	50	106	71	35	0,36
831.050.075	5705499401806	75	50	139	98	49	0,54
831.050.110	5705499401820	110	50	132	93	66	0,72
831.050.160	5705499412567	160	50	158	109	88	1,38
831.075.075	5705499401844	75	75	139	90	52	0,66
831.075.110	5705499401868	110	75	152	104	69	0,89
831.110.110	5705499401882	110	110	183	116	69	1,14
831.110.160	5705499401905	160	110	236	152	94	2,05
831.160.160	5705499401929	160	160	288	184	104	2,91

To comply with BS EN 12056 Gravity Drainage inside Buildings, when using non reducing branch consider branch type 836.

- Branches

DOUBLE BRANCH 87.5° TYPE 832

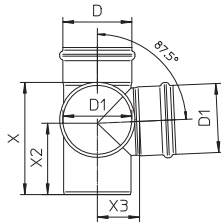

Type no.	EAN no.	D	D1	X	X2	X3	Kg
832.050.050	5705499401943	50	50	106	71	35	0,36
832.050.075	5705499401967	75	50	139	98	49	0,54
832.050.110	5705499401981	110	50	132	93	66	0,72
832.075.075	5705499402001	75	75	139	90	52	0,66
832.075.110	5705499402025	110	75	152	104	69	0,89
832.110.110	5705499402049	110	110	183	116	69	1,14
832.110.160	5705499402063	160	110	236	152	94	2,05
832.160.160	5705499402087	160	160	288	184	104	2,91

To comply with BS EN 12056 Gravity Drainage inside Buildings, when using non reducing branch consider branch type 837.

DOUBLE BRANCH 45° TYPE 836

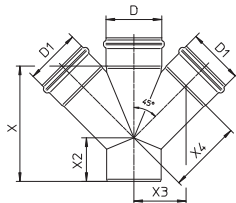

Type no.	EAN no.	D	D1	X	X2	X3	X4	Kg
836.050.050 S	5705499402117	50	50	128	57	54	76	0,59
836.050.075 S	5705499402131	75	50	144	56	66	94	0,69
836.050.110 S	5705499402155	110	50	147	42	84	119	0,80
836.075.075 S	5705499402179	75	75	183	74	78	110	1,15
836.075.110 S	5705499402193	110	75	182	60	95	135	1,31
836.110.110 S	5705499402216	110	110	233	88	105	149	2,10
836.110.125 S	5705499412574	125	110	250	90	110	155	1,65
836.110.160 S	5705499402223	160	110	258	80	131	186	2,85
836.125.125 S	5705499412581	125	125	273	103	120	170	2,10
836.160.160 S	5705499402230	160	160	331	120	156	221	5,28
836.200.200 S	5705499412598	200	200	415	151	194	274	5,28
836.250.250 S	5705499412604	250	250	512	177	236	334	7,01

DOUBLE BRANCH 45° TYPE 837

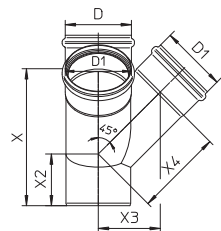

Type no.	EAN no.	D	D1	X	X2	X3	X4	Kg
837.050.050 S	5705499402254	50	50	128	57	54	76	0,49
837.050.075 S	5705499402278	75	50	144	56	66	94	0,67
837.050.110 S	5705499402285	110	50	147	42	84	119	0,92
837.075.075 S	5705499402292	75	75	183	74	78	110	1,43
837.075.110 S	5705499402308	110	75	182	60	95	135	1,31
837.110.110 S	5705499402322	110	110	233	88	105	149	2,07
837.110.160 S	5705499402339	160	110	258	80	131	186	2,07
837.160.160 S	5705499402346	160	160	331	120	156	221	4,02

OBLIQUE BRANCH 45° TYPE 838

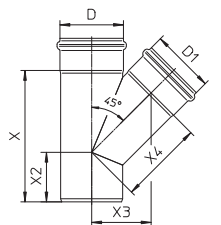

Type no.	EAN no.	D	D1	X	X2	X3	X4	Kg
838.040.040	5705499412994	40	40	118	58	45	63	0,25
838.040.050	5705499413014	50	40	119	55	50	71	0,30
838.050.050	5705499402353	50	50	133	62	54	76	0,32
838.050.075	5705499402377	75	50	144	56	66	94	0,48
838.050.082	5705499411980	82	50	149	57	72	102	0,54
838.050.110	5705499402391	110	50	147	42	84	119	0,70
838.075.075	5705499402414	75	75	183	78	78	110	0,64
838.075.082	5705499412000	82	75	185	75	81	114	0,70
838.075.110	5705499402438	110	75	181	60	95	135	0,88
838.075.125	5705499409314	125	75	200	65	100	141	1,32
838.082.082	5705499412024	82	82	195	80	83	118	0,75
838.110.110	5705499402452	110	110	236	91	105	149	1,16
838.110.125	5705499409338	125	110	250	90	110	155	1,50
838.110.160	5705499402476	160	110	258	80	131	186	2,11
838.125.125	5705499409352	125	125	273	103	120	170	1,49
838.160.160	5705499402490	160	160	331	120	156	220	3,04

Continues on next page

- Branches

**OBLIQUE BRANCH 45° TYPE 838**

Type no.	EAN no.	D	D1	X	X2	X3	X4	Kg
Continued from previous page								
838.160.200 S	5705499411027	200	160	359	123	177	250	4,37
838.200.200 S	5705499411034	200	200	415	151	194	274	5,47
838.200.250 S	5705499121650	250	200	432	142	217	307	6,61
838.250.250 S	5705499121667	250	250	512	177	236	334	8,57
838.250.315 S	5705499413878	315	250	518	154	270	416	12,48
838.315.315 S	5705499413885	315	315	621	200	294	382	16,53

**SWEPT BRANCH 87.5° TYPE 839**

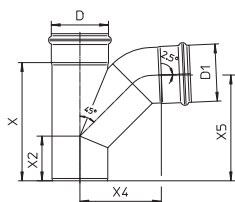

Type no.	EAN no.	D	D1	X	X2	X4	X5	Kg
839.050.050	5705499402513	50	50	133	62	84	121	0,44
839.050.075	5705499402537	75	50	144	56	97	128	0,60
839.050.110	5705499402551	110	50	147	42	115	132	0,81
839.075.075	5705499402575	75	75	183	78	114	160	0,87
839.075.110	5705499402599	110	75	182	60	130	160	1,11
839.110.110	5705499402612	110	110	236	91	161	212	1,64
839.110.160	5705499402636	160	110	258	80	186	227	2,53
839.160.160	5705499402650	160	160	331	120	223	298	4,52
839.200.200 S	5705499412611	200	200	415	151	428	434	6,13
839.250.250 S	5705499412628	250	250	512	177	535	525	9,67

**DOUBLE SWEPT BRANCH TYPE 879**

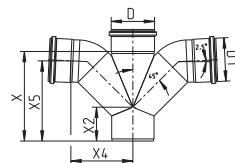

Type no.	EAN no.	D	D1	X	X2	X4	X5	Kg
879.110.110 S	5705499403916	110	110	233	88	161	208	1,80

- Access pipes and bends

**BEND 87.5° WITH ACCESS TYPE 822**

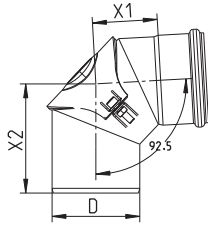

Type no.	EAN no.	D	X1	X2
822.090.075	5705499401509	75	57	102
822.090.110	5705499401523	110	81	137
822.090.160	5705499401547	160	112	205

For non pressurized system

**BRANCH 87.5° WITH ACCESS TYPE 834**

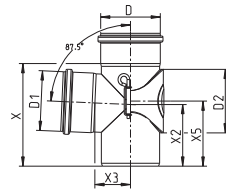

Type no.	EAN no.	D	D1	D2	X	X2	X3	X5
834.110.110 S	5705499409284	110	110	120	194	117	67	123
834.160.160 S	5705499409307	160	160	120	277	176	86	208

For non pressurized system.

To comply with BS EN 12056 Gravity Drainage inside Buildings, when using non reducing branch consider branch type 838, 848 or 839.

**PIPE WITH ACCESS TYPE 840**

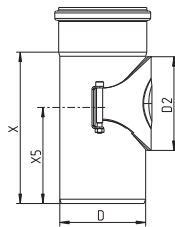

Type no.	EAN no.	D	D2	X	X5
840.075.075	5705499402674	75	80	139	92
840.110.110	5705499403794	110	120	194	123
840.111.110	5705499402698	110	120	253	187
840.125.125 S	5705499411058	125	120	195	128
840.160.160	5705499402711	160	120	277	208
840.200.200 S	5705499412215	200	120	288	208

For non pressurized system

**PIPE WITH ACCESS TYPE 840.000**

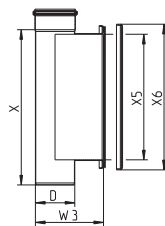

Type no.	EAN no.	D	W3	X	X5	X6
840.000.110 S	5705499127553	110	190	433	350	406
840.000.160 S	5705499127560	160	265	499	400	456
840.000.200 S	5705499127577	200	330	618	500	556
840.000.250 S	5705499127584	250	405	742	600	656

For below ground

- Access pipes and bends

**PIPE WITH ACCESS TYPE 813**

IMPACT RESISTANT

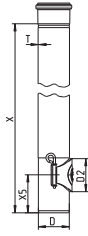

Type no.	EAN no.	D	D2	X	X5	T
813.150.075	5705499413557	75	80	1500	92	2
813.150.110	5705499413540	110	120	1500	123	2

For non pressurized system

- Sockets

**DOUBLE COUPLING TYPE 841**

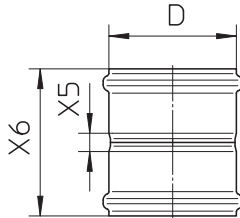

Type no.	EAN no.	D	X5	X6	Kg
841.040.040	5705499413038	40	20	104	0,13
841.050.050	5705499402735	50	13	97	0,15
841.075.075	5705499402759	75	20	120	0,26
841.082.082 S	5705499412048	82	20	124	0,31
841.110.110	5705499402773	110	16	130	0,45
841.125.125	5705499409475	125	20	140	0,54
841.160.160	5705499402797	160	20	162	1,05
841.200.200 S	5705499411065	200	20	200	1,85
841.250.250 S	5705499121674	250	30	246	3,11
841.315.315 S	5705499413908	315	30	262	5,36

**DOUBLE SLIP COUPLING TYPE 842**

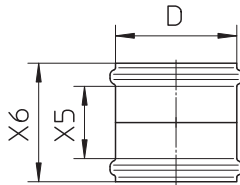

Type no.	EAN no.	D	X5	X6	Kg
842.040.040 S	5705499413069	40	76	104	0,13
842.050.050 S	5705499402810	50	71	97	0,12
842.075.075 S	5705499402827	75	91	120	0,21
842.082.082 S	5705499412055	82	95	124	0,31
842.110.110 S	5705499402834	110	97	130	0,45
842.125.125 S	5705499409550	125	104	140	0,47
842.160.160 S	5705499402841	160	118	162	1,05
842.200.200 S	5705499411072	200	147	200	1,82
842.250.250 S	5705499121681	250	173	264	3,11
842.315.315 S	5705499413915	315	177	262	5,36

**EXPANSION SOCKET TYPE 843**

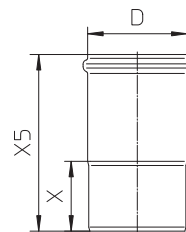

Type no.	EAN no.	D	X	X5	Kg
843.095.040	5705499413076	40	55	150	0,17
843.105.050	5705499402858	50	57	159	0,21
843.115.075	5705499402872	75	62	175	0,36
843.125.110	5705499402896	110	79	200	0,57
843.140.125	5705499122503	125	100	240	0,81
843.182.160	5705499402919	160	122	292	1,55

**EXPANSION SOCKET, LONG MODEL TYPE 869**

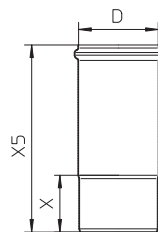

Type no.	EAN no.	D	X	X5	Kg
869.143.050	5705499410617	50	57	200	0,25
869.163.075	5705499410631	75	62	225	0,40
869.170.082	5705499121339	82	70	240	0,54
869.181.110	5705499410655	110	79	260	0,70
869.200.125	5705499412192	125	100	300	0,99
869.238.160	5705499410679	160	122	360	1,85
869.300.200 S	5705499121353	200	120	420	2,43

- Increasers and reducers

**INCREASER ECCENTRIC TYPE 850**

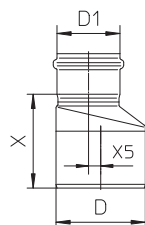

Type no.	EAN no.	D	D1	X	X5	Kg
850.040.050 S	5705499413397	50	40	85	5	0,16
850.050.075	5705499403084	75	50	87	7	0,22
850.050.082 S	5705499412062	82	50	97	14	0,25
850.050.110	5705499403107	110	50	114	25	0,38
850.075.110	5705499403138	110	75	116	15	0,42
850.075.160	5705499403169	160	75	178	37	1,20
850.082.110 S	5705499412086	110	82	111	11	0,43
850.110.125 S	5705499413410	125	110	109	8	0,49
850.110.160	5705499403206	160	110	140	22	1,06
850.125.160 S	5705499413427	160	125	138	18	0,95
850.160.200 S	5705499413434	200	160	165	20	1,67
850.200.250 S	5705499413441	250	200	195	25	2,57
850.200.315 S	5705499413953	315	200	280	58	4,61
850.250.315 S	5705499413977	315	250	242	33	4,82

**INCREASER CONCENTRIC TYPE 850**

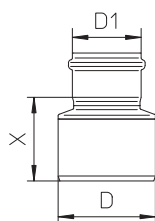

Type no.	EAN no.	D	D1	X	Kg
850.040.050 CS	5705499413991	50	40	65	0,13
850.050.075 CS	5705499409734	75	50	82	0,20
850.050.110 CS	5705499408454	110	50	94	0,30
850.075.082 CS	5705499412079	82	75	96	0,29
850.075.110 C	5705499403145	110	75	95	0,37
850.082.110 CS	5705499412093	110	82	110	1,00
850.110.125 CS	5705499409758	125	110	103	0,52
850.110.160 CS	5705499408461	160	110	117	1,00
850.125.160 CS	5705499408478	160	125	145	1,00
850.160.200 CS	5705499411096	200	160	170	1,50
850.200.250 CS	5705499121698	250	200	176	1,98
850.200.315 CS	5705499413946	315	200	223	4,11
850.250.315 CS	5705499413960	315	250	180	3,74

**REDUCER ECCENTRIC TYPE 850**

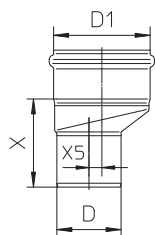

Type no.	EAN no.	D	D1	X	X5	Kg
850.050.040 S	5705499403961	40	50	77	5	0,10
850.075.050 S	5705499403121	50	75	80	7	0,28
850.110.050 S	5705499403183	50	110	99	25	0,50
850.110.075 S	5705499403190	75	110	104	15	0,55
850.110.082 S	5705499413342	82	110	101	11	0,29
850.125.110 S	5705499413359	110	125	96	8	1,00
850.160.110 S	5705499408485	110	160	123	22	1,08
850.160.125 S	5705499413366	125	160	136	18	0,50
850.200.160 S	5705499413373	160	200	153	20	1,77
850.250.200 S	5705499413380	200	250	192	25	1,00
850.315.250 S	5705499413984	250	315	229	33	4,93

**REDUCER CONCENTRIC TYPE 850**

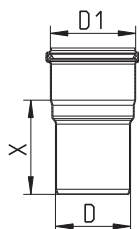

Type no.	EAN no.	D	D1	X	Kg
850.050.032 S	5705499403053	32	50	52	0,15
850.082.075 CS	5705499413465	75	82	94	1,00



- Adaptors

FLANGE ADAPTOR TYPE 850.015

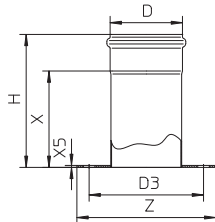

Type no.	EAN no.	D	Z.	H.	D3	X	X5
850.015.110 S FL	5705499409710	110	Ø216	207	178	150	3
850.015.160 S FL	5705499409727	160	Ø280	207	235	150	3

ADAPTOR FOR CLAY PIPE TYPE 851

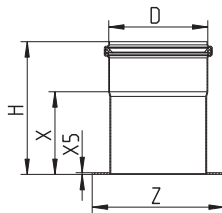

Type no.	EAN no.	D	Z.	H.	X	X5
851.150.110 S	5705499403237	110	Ø150	151	94	2
851.200.160 S	5705499403244	160	Ø200	195	125	1.3

ADAPTOR FOR PVC PIPE TYPE 852

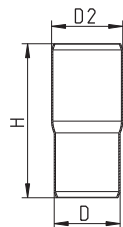

Type no.	EAN no.	D	H.	D2
852.050.054 S	5705499409772	50	117	54
852.075.082 S	5705499409796	75	123	82

ADAPTOR FOR PVC PIPE TYPE 852

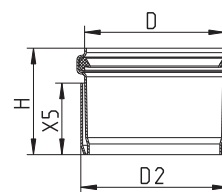

Type no.	EAN no.	D	H.	D2	X5
852.050.054 S0S	5705499409789	50	49	54	30
852.075.082 S0S	5705499409802	75	60	82	40

ADAPTOR FOR PVC PIPE TYPE 852

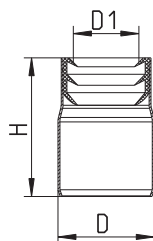

Type no.	EAN no.	D	D1	H.
852.075.052	5705499126709	75	52	108

- Adaptors

**ADAPTOR FOR CAST IRON PIPE TYPE 853**

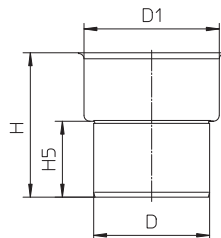

Type no.	EAN no.	D	D1	H.	H5.
853.093.075 S	5705499403251	75	93	125	66
853.127.110 S	5705499403268	110	127	141	76

Please order rubber insert type 803 separately

**DIN FLANGE ADAPTOR TYPE 854.X00**

WITH SOCKET AND FLANGE PN16 DIN 2633/EN1092-1

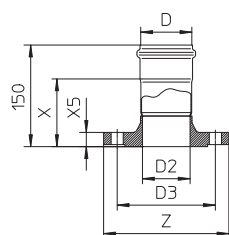

Type no.	EAN no.	D	Z.	D2	D3	X	X5	Kg
854.200.040 S	5705499413205	40	Ø150	43	110	108	18	2,21
854.200.050 S	5705499403831	50	Ø150	43	110	108	18	2,10
854.200.075 S	5705499403848	75	Ø185	70	145	100	18	3,40
854.300.040 S	5705499413212	40	Ø165	55	125	108	18	2,62
854.300.050 S	5705499403879	50	Ø165	55	125	108	18	2,80
854.300.110 S	5705499403886	110	Ø220	107	180	93	20	5,00

See blucher-marine.com for further information.

**DIN FLANGE ADAPTOR TYPE 854.X10**

WITH SPIGOT AND FLANGE PN16 DIN 2633/EN1092-1

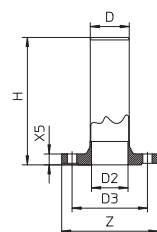

Type no.	EAN no.	D	Z.	H.	D2	D3	X5	Kg
854.210.040 S	5705499413229	40	Ø150	150	43	110	18	2,19
854.210.050 S	5705499403855	50	Ø150	234	43	110	18	2,32
854.210.075 S	5705499403862	75	Ø185	245	70	145	18	3,45
854.310.040 S	5705499413236	40	Ø165	150	55	125	18	2,60
854.310.050 S	5705499403893	50	Ø165	192	55	125	18	2,80
854.310.110 S	5705499403909	110	Ø220	259	107	180	20	5,15

See blucher-marine.com for further information.

**ANSI FLANGE ADAPTOR TYPE 854.025**

WITH SOCKET AND FLANGE ANSI B16.5

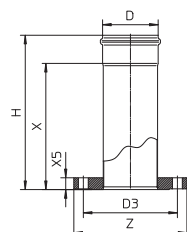

Type no.	EAN no.	D	Z.	H.	D3	X	X5	Kg
854.025.040 S	5705499413243	40	Ø152	292	121	250	19	2,56
854.025.050 S	5705499409871	50	Ø152	297	121	255	20	2,52
854.025.075 S	5705499409888	75	Ø191	305	153	255	24	4,72
854.025.110 S	5705499409895	110	Ø229	312	191	255	24	6,14
854.025.160 S	5705499409901	160	Ø279	328	242	255	24	6,50

See blucher-marine.com for further information.

- Adaptors

**ANSI FLANGE ADAPTOR TYPE 854.035**

WITH SPIGOT AND FLANGE ANSI B16.5

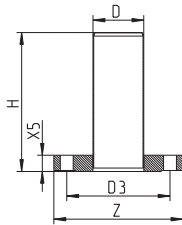

Type no.	EAN no.	D	Z	H	D3	X5	Kg
854.035.040 S	5705499413250	40	Ø152	200	121	19	2,56
854.035.050 S	5705499127591	50	Ø152	197	121	19	2,39
854.035.075 S	5705499127607	75	Ø191	205	152	24	4,52
854.035.110 S	5705499127614	110	Ø229	212	191	24	5,85

See blucher-marine.com for further information.

**FEMALE ADAPTOR TYPE 885.0**

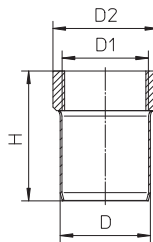

Type no.	EAN no.	D	D1	H	D2	Kg
885.032.040 S	5705499403954	40	1 1/4"	70	45	0,20
885.040.040 S	5705499403947	40	1 1/2"	73	57	0,20
885.025.050 S	5705499403435	50	1"	93	40	0,18
885.032.050 S	5705499403459	50	1 1/4"	72	48	0,17
885.040.050 S	5705499403466	50	1 1/2"	72	58	0,19
885.050.050 S	5705499403473	50	2"	77	67	0,22

BSP thread.

**MALE ADAPTOR TYPE 886.0**

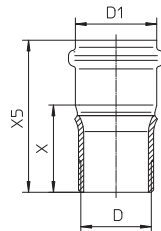

Type no.	EAN no.	D	D1	X	X5	Kg
886.050.032	5705499410693	1 1/4"	50	55	97	0,25
886.050.040 S	5705499403497	1 1/2"	50	56	98	0,23
886.050.050 S	5705499403503	2"	50	56	98	0,27

BSP thread.

**ADAPTOR TYPE 880**

FOR SHOWER DRAINS PRODUCED BEFORE 1998

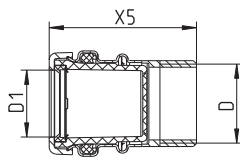

Type no.	EAN no.	D	D1	X5
880.032.000	5705499114331	1 1/4"	32	73

BSP thread.

- Adaptors

PIPE WITH 1½" SWIVEL NUT TYPE 851

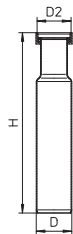

Type no.	EAN no.	D	H.	D2
851.025.040 S	5705499409765	50	205	1½"

BSP thread.

RUBBER INSERT TYPE 803

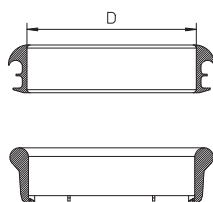

Type no.	EAN no.	D	Kg
803.MEN.075	5705499400144	75	0,14
803.MEN.110	5705499400151	110	0,20
803.MEN.160	5705499400168	160	0,26

PENETRATION TYPE 865

FOR VINYL FLOORS

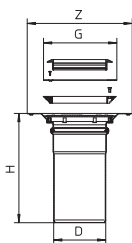

Type no.	EAN no.	D	Z.	G	H.
865.155.110	5705499403411	110	Ø222	Ø155	231

FEMALE ADAPTOR TYPE 885.1

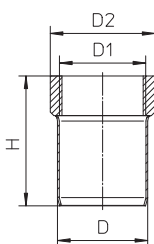

Type no.	EAN no.	D	D1	H	D2
885.125.050 S	5705499413618	50	1"	92	39
885.132.040 S	5705499413588	40	1¼"	73	48
885.132.050 S	5705499413601	50	1¼"	73	48
885.140.040 S	5705499413571	40	1½"	74	54
885.140.050 S	5705499413595	50	1½"	73	54
885.150.050 S	5705499413625	50	2"	83	66
885.175.075 S	5705499413632	75	3"	95	94

NPT thread.

## - Adaptors

## MALE ADAPTOR TYPE 886.1

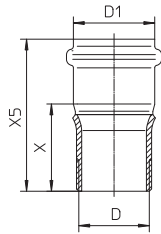

Type no.	EAN no.	D	D1	X	X5
886.150.032 S	5705499413656	1¼"	50	58	100
886.150.040 S	5705499413649	1½"	50	58	100
886.150.050 S	5705499413663	2"	50	57	99

NPT thread.

- Rat stops

**RAT STOP WITH ACCESS TYPE 891**

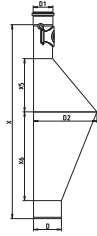

Type no.	EAN no.	D	D1	D2	X	X5	X6
891.075.110	5705499413472	110	75	250	764	210	350
891.110.110	5705499413489	110	110	250	814	210	350
891.125.125	5705499413496	125	125	250	836	210	350

For non pressurized system

**RAT STOP WITHOUT ACCESS TYPE 892**

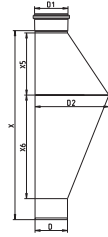

Type no.	EAN no.	D	D1	D2	X	X5	X6
892.075.110	5705499123425	110	75	250	678	210	350
892.110.110	5705499123432	110	110	250	640	210	350

- Toilet adaptors

TOILET ADAPTOR STRAIGHT TYPE 855.000

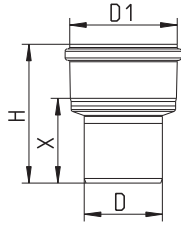

Type no.	EAN no.	D	D1	H.	X	Kg
855.000.082 S	5705499412116	82	110	147	90	0,41

TOILET ADAPTOR STRAIGHT TYPE 855.090

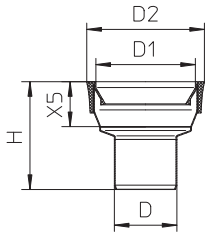

Type no.	EAN no.	D	D1	H.	D2	X5	Kg
855.090.075 S	5705499403299	75	110	130	133	55	0,42
855.090.082 S	5705499412123	82	110	137	133	55	0,51
855.090.110 S	5705499403305	110	110	126	133	55	0,39

TOILET ADAPTOR 68° TYPE 856

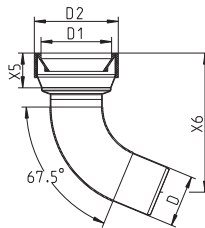

Type no.	EAN no.	D	D1	D2	X5	X6	Kg
856.090.082	5705499412130	82	110	133	55	220	1,26

TOILET ADAPTOR 90° TYPE 857

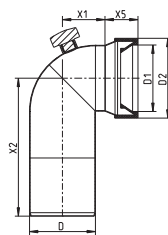

Type no.	EAN no.	D	D1	D2	X1	X2	X5	Kg
857.090.110	5705499403336	110	110	133	71	230	55	1,33

TOILET ADAPTOR 68° TYPE 858.068

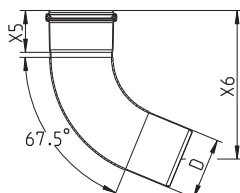

Type no.	EAN no.	D	X5	X6	Kg
858.068.082	5705499123487	82	55	197	0,86

- Toilet adaptors

TOILET ADAPTOR 68° TYPE 858.090

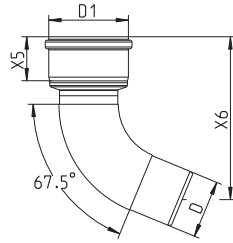

Type no.	EAN no.	D	D1	X5	X6	Kg
858.090.082	5705499412147	82	110	62	230	1,12



Water traps

**P-TRAP 87.5° TYPE 525**

WITH COUPLING AND DRAIN PLUG

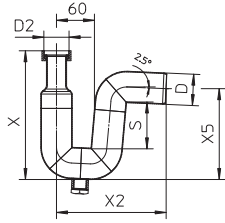

Type no.	EAN no.	D	S	D2	X	X2	X5
525.032.050 S	5705499114065	50	74	1 1/4"	205	175	145
525.040.050 S	5705499114072	50	74	1 1/2"	205	175	145
525.050.050 S	5705499114089	50	74	2"	205	175	145

BSP thread.

**P-TRAP 87.5° TYPE 525.090**

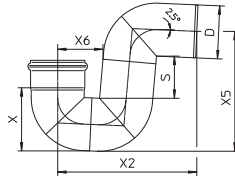

Type no.	EAN no.	D	S	X	X2	X5	X6
525.090.050 S	5705499101461	50	74	67	175	145	60
525.090.075 S	5705499101478	75	81	93	222	189	74
525.090.110 S	5705499101485	110	89	132	289	249	94
525.090.125 S	5705499117974	125	110	158	330	292	102
525.090.160 S	5705499101492	160	105	187	388	338	121

**FLOW RATES FOR P-TRAP 87.5° TYPE 525.090**

Type no.	EAN no.	Max Flow (l/s)
525.090.050 S	5705499101461	1.7
525.090.075 S	5705499101478	2.5
525.090.110 S	5705499101485	3.4
525.090.125 S	5705499117974	4.4
525.090.160 S	5705499101492	7.5

Accurate flow rate depending on installation.

**S-TRAP 180° TYPE 525.180**

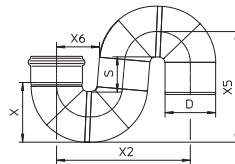

Type no.	EAN no.	D	S	X	X2	X5	X6
525.180.050 S	5705499114096	50	74	67	166	145	60
525.180.075 S	5705499114102	75	81	93	217	190	74
525.180.110 S	5705499114119	110	89	132	292	249	94
525.180.160 S	5705499114126	160	105	187	394	342	122

Water traps

**BOTTLE WATER TRAP TYPE 505**

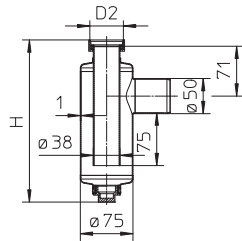

Type no.	EAN no.	H	D2
505.032.050 S	5705499101447	250	1¼"
505.040.050 S	5705499101454	233	1½"
505.050.050 S	5705499114058	243	2"

75 mm water seal. BSP thread.

Clamps

PIPE JOINT CLAMP TYPE 847

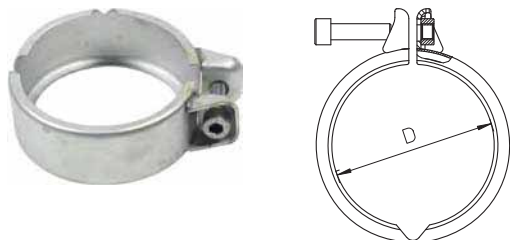

Type no.	EAN no.	D
847.040.040	5705499413090	40
847.050.050	5705499412420	50
847.075.075	5705499412437	75
847.082.082	5705499121322	82
847.110.110	5705499412444	110
847.125.125	5705499412451	125
847.160.160	5705499412468	160
847.200.200	5705499412475	200
847.250.250	5705499121773	250

CROSS RAKING FIXING FOR PIPE JOINT CLAMP TYPE 847

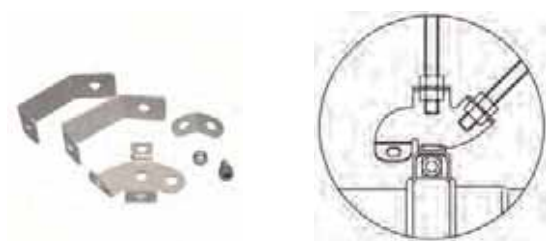

Type no.	EAN no.
847.000.000	5705499409628

To be used with pipe joint clamp type 847.

SADDLE CLAMP TYPE 890



Type no.	EAN no.	D	D1	X5	X6
890.075.040	5705499104776	75	32	68	126
890.075.050	5705499104837	75	50	70	124
890.110.040	5705499104806	110	32	68	163
890.110.050	5705499104813	110	50	70	159

D1=32mm fits D1=40mm as well.

PRESSURE PEAK PIPE JOINT CLAMP TYPE 847.001

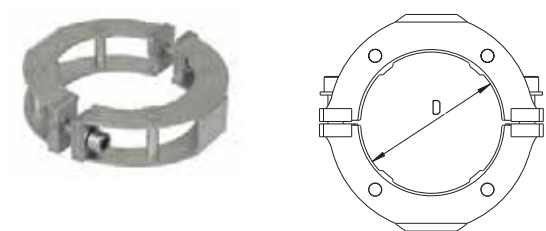

Type no.	EAN no.	D
847.001.040	5705499413106	40
847.001.050	5705499412499	50
847.001.075	5705499412505	75
847.001.082	5705499412512	82
847.001.110	5705499412529	110
847.001.125	5705499412536	125
847.001.160	5705499412543	160

Pipework can withstand brief pressure peaks when fitted with pressure peak joint clamps on all joints. Pipework D40 - D110 mm has been tested up to 10 bar and pipework D125 - D160 mm has been tested up to 7 bar. Not to be used instead of remotely operated valve.

Pipe hangers

PIPE HANGER WITH TPE RUBBER TYPE 860

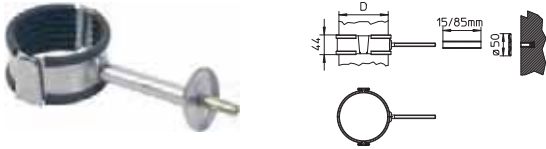

Type no.	EAN no.	D
860.040.050	5705499403350	50
860.040.075	5705499403367	75
860.040.110	5705499403374	110
860.040.160	5705499403381	160

PIPE HANGER WITH EPDM RUBBER TYPE 895.000

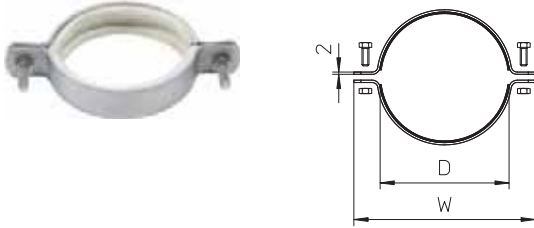

Type no.	EAN no.	D	W
895.000.050 GS	5705499403510	50	101
895.000.075 GS	5705499403527	75	126
895.000.110 GS	5705499403534	110	161
895.000.160 GS	5705499403541	160	211

PIPE HANGER WITH EPDM RUBBER TYPE 895.012

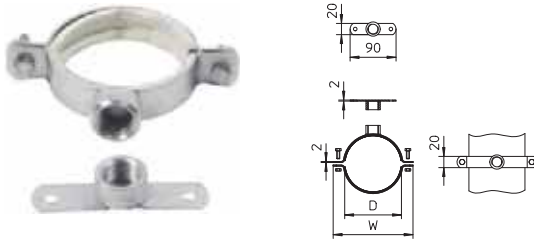

Type no.	EAN no.	D	W
895.012.040 GS	5705499413113	40	90
895.012.050 GS	5705499403558	50	101
895.012.075 GS	5705499403565	75	126
895.012.110 GS	5705499403572	110	161
895.012.160 GS	5705499403589	160	211

With 1/2" BSP thread.

PIPE HANGER WITH EPDM RUBBER TYPE 895.200

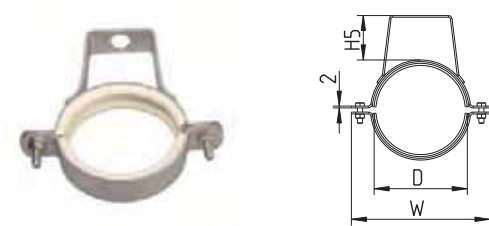

Type no.	EAN no.	D	H5	W
895.200.040 S	5705499413120	40	38	90
895.200.050 S	5705499410747	50	38	101
895.200.075 S	5705499410754	75	54	126
895.200.110 S	5705499410761	110	52	161
895.200.160 S	5705499410778	160	71	211

PIPE HANGER WITH EPDM RUBBER TYPE 895.300



Type no.	EAN no.	D	W
895.300.040 GS	5705499413137	40	90
895.300.050 GS	5705499403633	50	101
895.300.075 GS	5705499403640	75	126
895.300.110 GS	5705499403657	110	161
895.300.160 GS	5705499403664	160	211

Pipe hangers

**PIPE HANGER WITH EPDM RUBBER TYPE 895.401**  
IN GALVANIZED STEEL

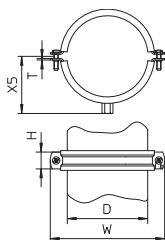

Type no.	EAN no.	D	H.	W	X5	T	Nut
895.401.040	5705499413144	40	20	83	41	1.25	M8/M10
895.401.050	5705499128024	50	20	97	49	1.25	M8/M10
895.401.075	5705499128031	75	23	122	61	2	M8/M10
895.401.110	5705499128048	110	23	157	78	2	M8/M10
895.401.125	5705499128055	125	23	169	84	2	M8/M10
895.401.160	5705499128062	160	25	233	108	3	M8/M10
895.401.200	5705499128079	200	25	273	122	3	M10
895.401.250	5705499128086	250	38	345	163	4	M16
895.401.315	5705499135312	315	48	414	198	5	M16

D=75mm fits D=82mm as well.

**PIPE HANGER WITH EPDM RUBBER TYPE 895.402**  
IN GALVANIZED STEEL

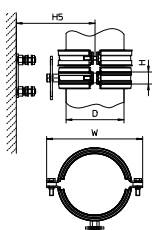

Type no.	EAN no.	D	H.	H5	W
895.402.075	5705499128109	75	25	83-96	154
895.402.110	5705499128116	110	25	100-110	176
895.402.125	5705499128123	125	25	108-118	199
895.402.160	5705499128130	160	25	127-137	234
895.402.200	5705499128147	200	25	152-162	274

Reducing noise transmission to the building.  
D=75mm fits D=82mm as well.

**PIPE HANGER WITH EPDM RUBBER TYPE 895.403**  
IN STAINLESS STEEL

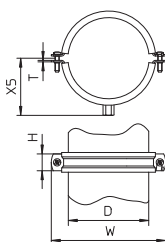

Type no.	EAN no.	D	H.	W	X5	T	Nut
895.403.040 S	5705499413168	40	20	85	32	1.5	M8
895.403.050 S	5705499128161	50	20	97	41	1.5	M8
895.403.075 S	5705499128178	75	20	118	51	2	M8
895.403.110 S	5705499128185	110	20	158	72	2.5	M10
895.403.125 S	5705499128192	125	20	170	78	2.5	M10
895.403.160 S	5705499128208	160	25	233	101	2.5	M10
895.403.200 S	5705499128215	200	25	273	123	3	M10
895.403.250 S	5705499128222	250	25	317	142	2.5	M10

D=75mm fits D=82mm as well.

Plugs

SOCKET PLUG TYPE 844.000

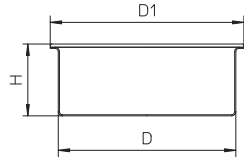

Type no.	EAN no.	D	D1	H.
844.000.040 S	5705499413175	40	50	47
844.000.050 S	5705499402933	50	58	50
844.000.075 S	5705499402940	75	85	45
844.000.110 S	5705499402957	110	120	45
844.000.125 S	5705499412222	125	135	43
844.000.160 S	5705499402964	160	170	45
844.000.200 S	5705499412239	200	210	50
844.000.250 S	5705499123654	250	265	65

Use of pipe joint clamp type 847 is necessary if any pressure in the pipe system is expected.

SOCKET PLUG TYPE 844

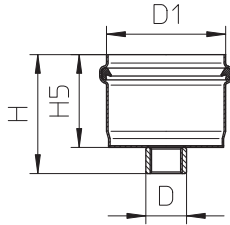

Type no.	EAN no.	D	D1	H.	H5.
844.069.050	5705499409567	½"	50	67	50
844.082.075	5705499409574	½"	75	78	61
844.087.110	5705499409581	½"	110	84	67

BSP thread.

SOCKET PLUG TYPE 844.100

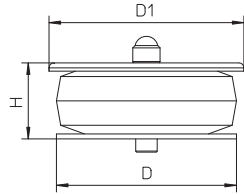

Type no.	EAN no.	D	D1	H.
844.100.050 S	5705499411393	50	59	31
844.100.075 S	5705499411409	75	83	36
844.100.082 S	5705499412109	82	90	36
844.100.110 S	5705499411416	110	118	36
845.000.160 S	5705499403008	160	170	45

Use of pipe joint clamp type 847 is recommended if the pressure in the pipe system is expected to exceed 0.5 bar for D<110mm and 0.3 bar for D=110mm.

Sealing rings

**EPDM LIP SEALING RING BLACK TYPE 801**

FOR STANDARD USE

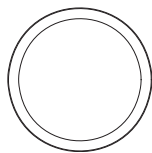
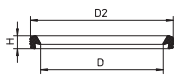

Type no.	EAN no.	D	H	D2
801.EPDM.032	5705499403923	32	6.0	39.5
801.EPDM.040	5705499403930	40	7.8	51.7
801.EPDM.050	5705499400038	50	7.8	61.8
801.EPDM.075	5705499400045	75	7.8	87.1
801.EPDM.082	5705499123524	82	8.0	93
801.EPDM.110	5705499400069	110	8.9	124.2
801.EPDM.125	5705499408096	125	10.2	142.3
801.EPDM.160	5705499400076	160	11.5	180.1
801.EPDM.200	5705499410785	200	12.8	223.8
801.EPDM.250	5705499121704	250	19	282
801.EPDM.315	5705499413700	315	20	350

**FPM LIP SEALING RING TYPE 801**

FOR HIGH TEMPERATURES

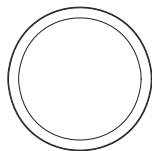
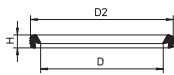

Type no.	EAN no.	D	H	D2
801.FPM.040	5705499413458	40	7.8	51.7
801.FPM.050	5705499408102	50	7.8	61.8
801.FPM.075	5705499408119	75	7.8	87.1
801.FPM.110	5705499408126	110	8.9	124.2
801.FPM.125	5705499410792	125	10.2	142.3
801.FPM.160	5705499408133	160	11.5	180.1
801.FPM.200	5705499410808	200	12.8	223.8
801.FPM.250	5705499121728	250	19	282
801.FPM.315	5705499413717	315	20	350

**NBR LIP SEALING RING BLACK/YELLOW TYPE 801**

FOR USE WITH OIL

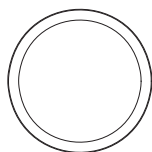
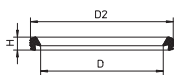

Type no.	EAN no.	D	H	D2
801.NBR.040	5705499413182	40	7.8	51.7
801.NBR.050	5705499400106	50	7.8	61.8
801.NBR.075	5705499400113	75	7.8	87.1
801.NBR.110	5705499400120	110	8.9	124.2
801.NBR.125	5705499410815	125	10.2	142.3
801.NBR.160	5705499400137	160	11.5	180.1
801.NBR.200	5705499410822	200	12.8	223.8
801.NBR.250	5705499121711	250	19	282
801.NBR.315	5705499413724	315	20	350

**SI LIP SEALING TYPE 801**

FOR USE IN FIRE-APPROVED PRODUCTS

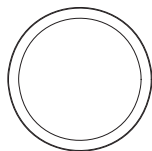
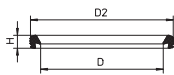

Type no.	EAN no.	D	H	D2
801.SI.040	5705499413199	40	7.8	51.7
801.SI.050	5705499408140	50	7.8	61.8
801.SI.075	5705499408157	75	7.8	87.1
801.SI.110	5705499408164	110	8.9	124.2
801.SI.160	5705499408171	160	11.5	180.1

## MANUAL PIPE CUTTER

Cutting is done by a special disc cutter, which cuts and grips at the same time.

N.B.: Do not cut fittings.



Type no.	EAN no.	Designation
006.050.110	5705499000061	Manual pipe cutter (40 - 110 mm)
006.125.200	5705499001020	Manual pipe cutter (110 - 200 mm)
006.200.315	5705499123531	Manual pipe cutter (200 - 315 mm)
006.000.005	5705499000023	Spindle for 006.050.110
006.000.000	5705499000016	Cutting disc for 006.050.110
006.000.001	5705499001068	Cutting disc for 006.125.200 & 006.200.315

## ELECTRICAL PIPE CUTTER

Cutting time:  
Seconds.

Changeover time:  
Changeover from one cutting disc to another can be effected within a matter of seconds.

Cutting quality:  
The cutting motion has been developed to produce a bevelled leading edge to cut ends. As a result only the application of BLÜCHER jointing lubricant is required prior to jointing cut ends.

Power supply:  
110 Volt/Min 2 kVA/60 Hz or 220 Volt/50 Hz.

Pipe diametres:  
50-160 mm

N.B.: Do not cut fittings.



Type no.	EAN no.	Designation
800.050.160	5705499400021	Electrical pipe cutter 220 V
800.050.160 GB	5705499000184	Electrical pipe cutter 110 V, 16 A
800.050.160 US	5705499000191	Electrical pipe cutter 110 V, USA plug
800.030.006	5705499400014	Cutting disc
006.050.160	5705499124132	Support base for electrical pipe cutter

## CUTTING OIL/JOINTING LUBRICANT

Jointing lubricant is applied to make jointing a simple action. After a few days the lubricant will dry out and lose its lubricity making subsequent demounting of a joint difficult. If subsequent demounting of joints can be envisaged then we can supply a silicone based lubricant that will not dry out. BLÜCHER jointing lubricant is based on a mild and harmless liquid detergent that is biologically degradable. BLÜCHER cutting oil is recommended for use with BLÜCHER® EuroPipe pipe cutters.



Type no.	EAN no.	Designation
007.000.000	5705499000078	Atomizer
007.100.050	5705499000085	Jointing lubricant 0.5 L
007.500.050	5705499000092	Cutting oil 0.5 L

## ASSEMBLY TOOL



Type no.	EAN no.	Designation
806.000.160	5705499124149	For pipes D=160mm
806.000.200	5705499123500	For pipes D=200mm
806.000.250	5705499124156	For pipes D=250mm



**DIMPLING JAWS**

FOR PRESSING PROJECTIONS ON PIPES



Type no.	EAN no.
800.200.001	5705499403978

**BLÜCHER®**  
A **WATTS** Brand

At BLÜCHER® more than 300 employees create an annual turnover of more than 50 million euro.

Through know-how, dedicated service and common sense we develop, produce and market high quality stainless steel drainage solutions for customers within the housing, commercial, industrial and marine sectors all over the world.

Find your local BLÜCHER® specialist at [www.blucher.com](http://www.blucher.com)

**BLÜCHER® EuroPipe**

**BLÜCHER® Channel**

**BLÜCHER® EuroPipe**



**BLÜCHER Metal A/S**

Pugdalvej 1

DK-7480 Vildbjerg

Denmark

Tel.: +45 99 92 08 00

Email: [export@blucher.com](mailto:export@blucher.com)

[www.blucher.com](http://www.blucher.com)